

DISTRICT EIGHT



10.46 N 106.42 E

VIỆT NAM

MADE IN SÀI GÒN



District Eight is a furniture brand established in 2010 amidst the bustling streets of Sài Gòn, Việt Nam. The name refers to one of the city's 24 districts, in the heart of which the first humble factory and office was set up. District Eight designs and crafts products that tell a unique story to Việt Nam with a confident take on contemporary living and an understanding of modern elegance.





**WE DESIGN AND CREATE QUALITY FURNITURE
INSPIRED BY VIETNAMESE HERITAGE.**

Carefully crafted and delivered to high-quality standards, District Eight's defining signature comes from its innate passion and commitment to elevate workmanship, refining aesthetics, and reframing functionality. The connection to the rich cultures and heritage of the land inspires a continuous exploration of techniques and solutions that bring authentic ideas and premium materials to life.

From the initial concept to development, from the artisan's touch to the meticulous production, District Eight seeks to blend global insights with the tradition of dedicated craftsmanship in Việt Nam through every considered detail. Since 2010, our distinctive designs have propelled beyond domestic borders to the global stage – inspiring international recognition and becoming synonymous with Việt Nam's creative energy.

Crafted From Ideas

The inspiration of District Eight often comes from pre-contemporary architecture, as it appears that until the middle of 20th century, furniture and objects were designed with a sense of purpose by architects themselves, rather than being mere disposable decoration.

Made, Manufactured, Crafted

The ethos of District Eight design and production was established early on. Our products are made to be used reliably and to be durable through wear and tear, just like industrial tools or workwear would. This level of quality can only be achieved with the right balance of machinery and crafty hands.

Craft As Past, Present & Future

Our spaces are conceived to convey subtle elements of lifestyle. By working with rich textures, tonal color schemes, and curated artworks, District Eight aims at offering a unique experience, about craft and livability.

As the creative industries and the local environment evolve, District Eight has also made strides into new creative expressions and crafts. The approach is developed especially for contemporary spaces, where private and public norms are converging.



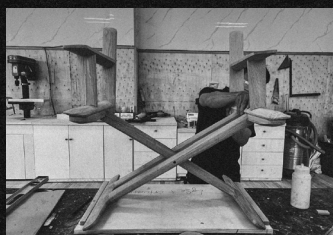
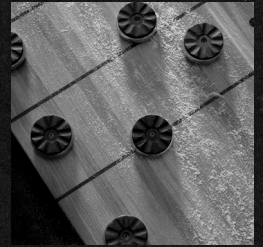

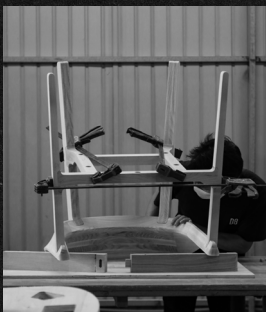
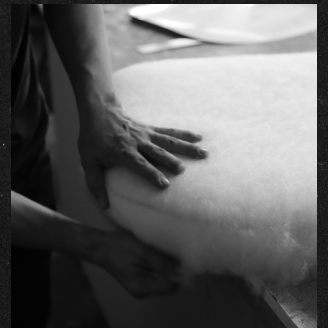



BUOM

P. 05

designed by
Jean-Marie Massaud



BOW

P. 13

designed by
Monica Förster



ORA

P. 19

designed by
Ina Rinderknecht



NÔM

P. 29



ODETTE / DESK

P. 33



NEN

P. 35



BAGUA

P. 41



TONKIN
/ CONSOLE - LOW

P. 47





BUOM

*Designed by
Jean-Marie Massaud*

BUOM reinvents a familiar archetype with sophistication.

This solitary Lounge chair combines the elegance of suspended comfort with the sensuality of a robust structure. Its leather seat is moulded after the silhouette of full-blown sails, known as *buồm*, in Vietnamese traditional boat, and through expert craftsmanship, appears as if it's only touching the slanted legs. The solid oak frame enhances its sturdy support, with cross stretchers forming a visual dynamic with the seat's undulating lines.

BUOM is the timeless companion that embodies our demands for lightness and refinement.

" I LOVE THE ELEGANCE OF LIGHT THINGS."













TONKIN CONSOLE LOW
Smoked Oak
Antique Brass

JOSS SOFA
Echo Thunder
Dark Seared Oak



FAIFO COFFEE TABLE
Burned Fir

BUOM LOUNGE CHAIR
Amos Light Leather
Ebonized Oak



BOW

*Designed by
Monica Förster*

BOW intrigues and enchants with a seat that appears to float. Its curved, inviting lines create the feeling of an Asian roof tile when many chairs are put together. Highly crafted precision gives the design an air of lightness, with tapered legs and curvilinear stretchers composing its soft, elegant profile. The backrest and seat follow an embracing, upholstered contour that eases the body into relaxation.

Finely sculpted solid oak defines the chair's material warmth, and underlines its contemporary sophistication.

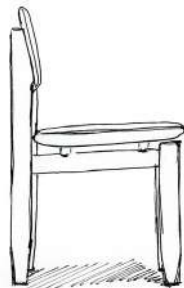







NEN CABINET
Beige Oak
Antique Nickel

FAIFO ROUND DINING TABLE
Burned Fir

BOW CHAIR
Omari Ink Black Leather
Ebonized Oak

BOW CHAIR
Echo Thunder
Beige Oak





ORA

*Designed by
Ina Rinderknecht*

Inspired by the soft, subtle hues and shapes of traditional Asian celadon ceramics, ORA exudes a quiet yet undeniable elegance and presence. The egg-shape marble top, paired with rich solid oak, creates a striking combination that radiates both warmth and refinement. Its modern, organic shape effortlessly complements both contemporary and classic interiors. The detachable Lazy Susan allows for easy sharing and serving, or can also be used for the table's centrepiece. The distinctive pedestal base, enveloped in oak, elevates ORA from mere furniture to a true work of art.







ORA DINING TABLE
Ebonized Oak
Athena Grey Marble

NÔM CHAIR
Omari Ink Black Leather
Ebonized Oak



NÔM CHAIR WITH ARMS
Omari Ink Black
Ebonized Oak







NEN CABINET
Ebonized Oak
Antique Brass



NÔM CHAIR WITH ARMS
Fler Taupe
Dark Seared Oak

NÔM CHAIR
Fler Taupe
Beige Oak

ODETTE DESK
Dark Seared Oak



NÔM



Nôm is inspired by the calligraphy brushstrokes in *chữ Nôm*, a Vietnamese script of vernacularized Chinese characters once widely used by the country's learned class prior to the 20th century. The chair's frame is sculpted from solid oak, with fluid yet firm lines drawn from the balance and rhythm of ink flow. Joints are hand-sanded to create the aesthetic effect of seamless transitions. Refined textile upholstery rounds off its well-balanced seat, whose sense of grounding is comfortably felt from every angle.





ODETTE

DESK



Where pure tactility can be felt in all immersive details, the Odette desk adopts the distinctness of its namesake collection to a new size, perfect for a private study or compact workspace. Its frame is crafted from solid oak, featuring stretchers interlocked in a composition that references the enduring structure of wood beams and columns in traditional Eastern architecture. Drawers add to its relaxed utility, where ease of use and natural elegance come together through expert craftsmanship.





NEN

Named after the Vietnamese word for “foundation”, our new storage collection is rooted in utilitarian and meticulous simplicity. With lines pared down to the minimal, the design takes on a calm, monolithic silhouette. A raised rectilinear platform composes NEN'S distinct visual profile, also the basis for its stability. Inner compartments built from sycamore offer a fine-grained color contrast with the solid oak finishes on the frame. Metal handles texturally juxtapose with the warm materiality of woods, and further highlight the design's symmetrical harmony.







INUMBRA SHELF
Ebonized Oak
Antique Nickel



BAGUA SOFA
Sila Fog
Dark Seared Oak

BAGUA LOUNGE CHAIR
Sila Fog
Dark Seared Oak

FAIFO COFFEE TABLE
Burned Fir



BAGUA



Our new sofa collection is inspired by the ancient diagram of *bagua*, in which the relationships of yin and yang are illustrated through symbols arranged in octagonal formations. An eight-sided oak base underpins the sofa's grounded structure. With full upholstery enfolds its enveloping contour, the seat bestirs plenitude of comfort. Perfect for intimate nooks or modest spaces, BAGUA casts a strong, graceful presence that blends well with contemporary decorations and lifestyles.







FAIFO

COFEEE TABLE



The new Faifo variant is understated yet characterful. Perfect for commodious interiors, its sizable top provides a pleasing canvas to arrange more of your everyday objects. The hand-finished wood frame features three wings of legs, intriguing to behold from any angle. Made from solid oak or fir, it fully embraces the warm and natural beauty of wood grains. Available in a variety of color finishes and size variants, the collection brings in inspired possibilities tailored to your taste and needs.



TONKIN

CONSOLE

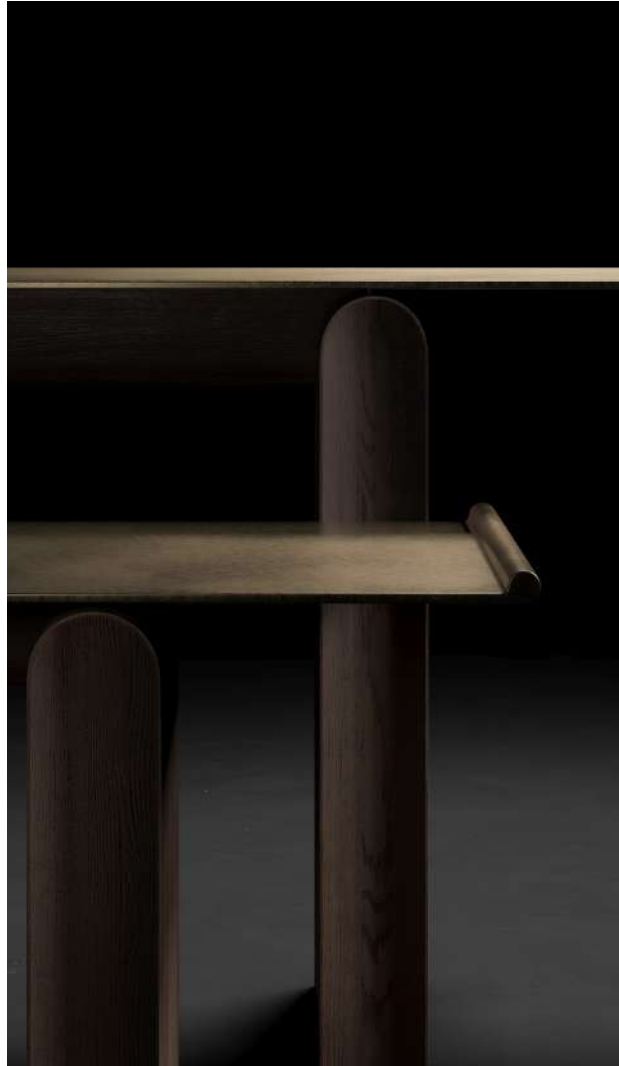

Our Tonkin console now comes in two new variants. Proportioned to offer more versatility for interior stylings, they expand on the original design's silhouette which references traditional temple gates in East Asian cultures. The console's minimal contour artfully blends curves and straight lines, subtly pronouncing the beauty of well-honed materials. Refined joinery lends it an air of lightness, where the hand-polished steel top appears to gently rest on the sculpted, solid oak base.

**DESIGNER
COLLABORATIONS**

JEAN-MARIE MASSAUD



District Eight's distinction as a forward-thinking and detail-focused maker of Vietnamese contemporary design has piqued the interest and imagination of some of the world's leading designers. Their collections amalgamate craft and culture into life-enhancing designs, whereby tactile values and emotional connection are as invested as visual originality. More than a shared passion for technical excellence, these collaborations express our deep engagement with the rich heritage of Asia and its reinterpretation through the inventive language of design.

"Easy + Chic x Light + Robust x Trendy + Evergreen."

"I love the elegance of light things."



MONICA FÖRSTER



"The idea with the chair has been to communicate the international and Asian angles mixed together."

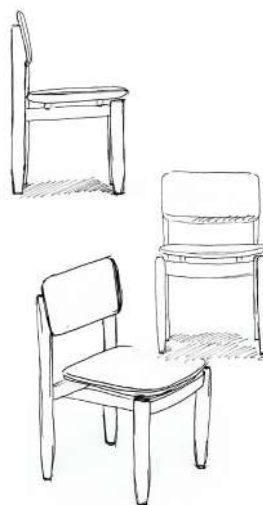

INA RINDERKNECHT



"ORA is more than just a functional piece, it's an invitation to meaningful conversations. Its presence strikes the perfect balance – neither overly feminine nor too imposing. Combining luxury, functionality, and timeless design, this table is a true statement of traditional craftsmanship and style."

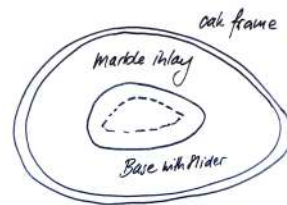

TOAN NGUYEN



"If Joss conceals details that attract the eye and the hand without ostentation, it is harmony and serenity that prevail."

"Stilt is the result of a quest for harmony in contrast."

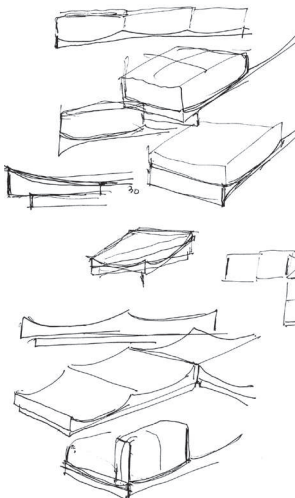

MICHELE DE LUCCHI



"In District Eight, I recognize a design attitude that's very typically Italian towards high quality products – the result of a perpetual curiosity towards technical possibilities, a deeply rooted humanistic sensibility and a strong innovative undertone."

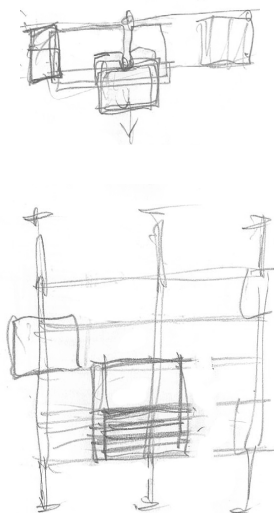

STUDIOUTTE



"The collection is an homage to a radical timeless elegance, suspended between Eastern influences and a minimalist approach. It aspires to silently enter the most intimate domestic spaces as if it had always been there."

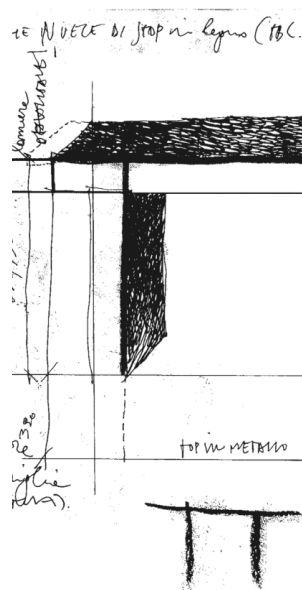

ADAM GOODRUM



"A metaphorical love letter to timber craftsmanship"

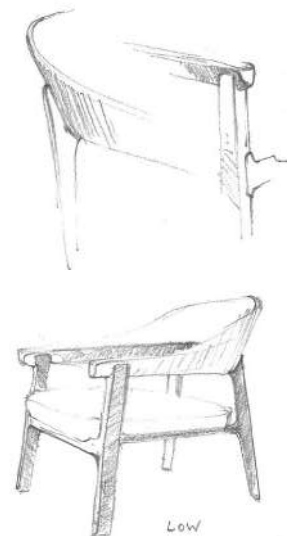

STYLE INDEX

The drawings refer to the compositions as shown in the pictures. For further information on availability on sizes, we kindly ask you to get in touch with our stores.

BUOM

Designed by
Jean-Marie Massaud

- Oak frame / Leather / Steel

Lounge Chair
2042-AMCH

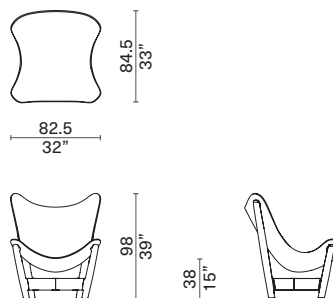

BOW

Designed by
Monica Förster

- Oak Frame / Upholstered
Seat & Backrest

Dining Chair
2041-ALES

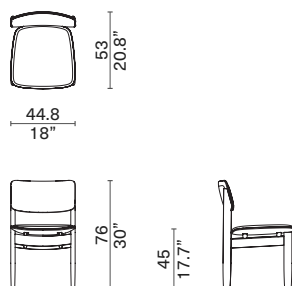

ORA

Designed by
Ina Rinderknecht

- Oak Frame / Marbel top

Dining Table
1034-DNTB

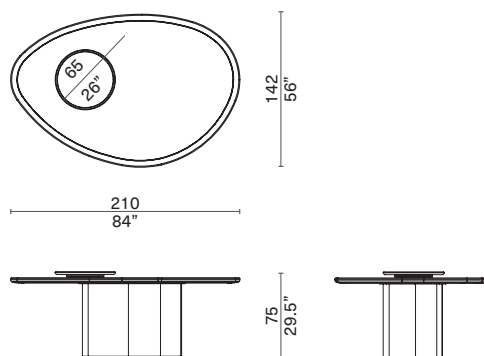

BAGUA

- Oak frame / Upholstered
Seat

Lounge Chair
2039-LGCH

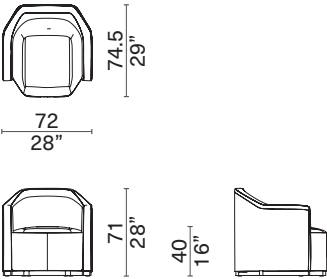

Sofa 2-seater
2039-2SEA

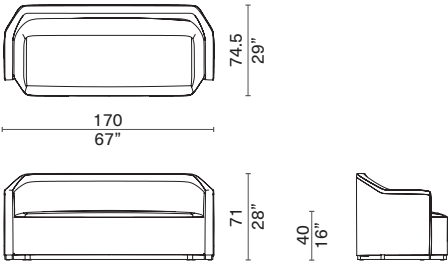

FAIFO

- Oak Frame

Coffee Table
D8ST-1010-SITB

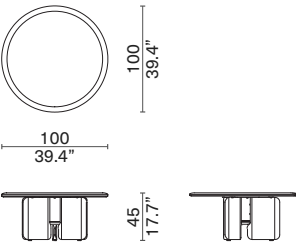

ODETTE

- Oak / Metal In Steel

Rectangular Desk - Small
D8ST-1017-DESK-RE-SML

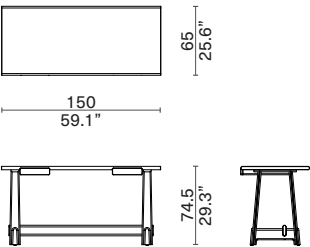

Rectangular Desk - Medium
D8ST-1017-DESK-RE-MED

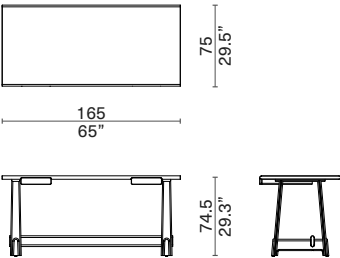

NEN

- Oak / Steel

Sideboard
3022-SIBO

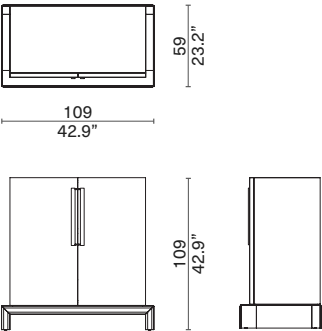

Dresser
3022-DRES

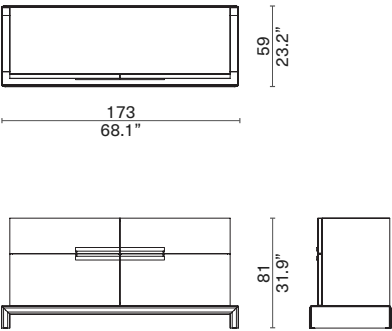

NOM

- Upholstery / Oak

Dining Chair
2040-ALES-SFBR

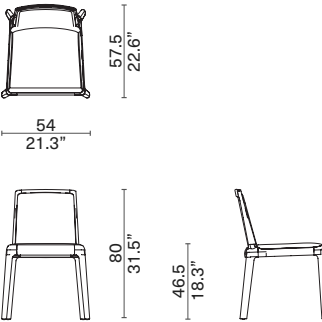

Dining Chair with Arms
2040-SFBR

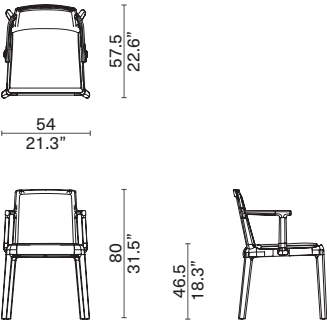

TONKIN

- Oak Wood / Oak Veneer /
Metal In Steel

Console
1012

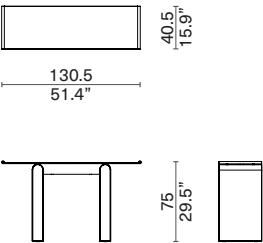

Console - Low
D8ST-1012-SBCS

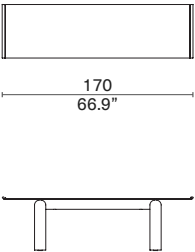

Console - Long
D8ST-1012-CSLO

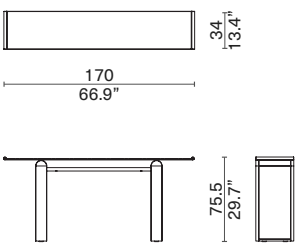





DINH /zĩŋɦɦ/ – the new edition of District Eight's Games Collection – lends its name from the Vietnamese word for 'mansion,' 'villa,' or 'palace.'

In Saigon, an architectural style known as Vietnamese modernism reigned supreme during the mid-20th century. Its blend of international ideas and vernacular ingenuity still defines much of the city's urban landscapes, and inspires our latest take on the Games' table design.

Many of Saigon's modernist structures are visual stories unto themselves. Geometric patterns figure prominently on the buildings' facades. Brise-soleil, devised to mitigate exposure to the elements in tropical climate, is a common feature that also reflects the local's long-held relatedness to nature, as it generates the subtle interplay between shadow and light, interior and exterior.

The modernist principles of clean lines and minimal ornamentation are inherent in buildings' composition. However, intrinsic too are functional yet expressive arrangements of columns, louvers, beams and loggias. The overall effect is a distinct aesthetic that captures the Vietnamese sensitivity for harmony and balance.

That timeless spirit is translated into DINH, in which classic game tables are reimagined as soulful collectibles for the contemporary home. In this new edition, woodworking craft takes center stage and forms the tables' sculptural build, whose monolithic frame mirrors the elegant placement of beams and columns that characterize Vietnamese modernist structures. Handcrafted features, namely the leather net on DINH Ping Pong Table or leather edges on DINH Mahjong and Poker Tables, further highlight the collection's nuanced aesthetic.

A retelling of Saigon and its creative heritage, the DINH edition embodies District Eight's passion for elevating crafts. From the initial concept to development, from the artisan's touch to the meticulous production line, every detail is infused with intention and dedication, resulting in designs of exceptional worth and character – of which our Games collection is a prime example.

DINH GAMES COLLECTION

Foosball Table P. 59

Mahjong Table P. 63

Ping Pong Table P.67

Poker Table P. 71

Shuffleboard Table P. 75



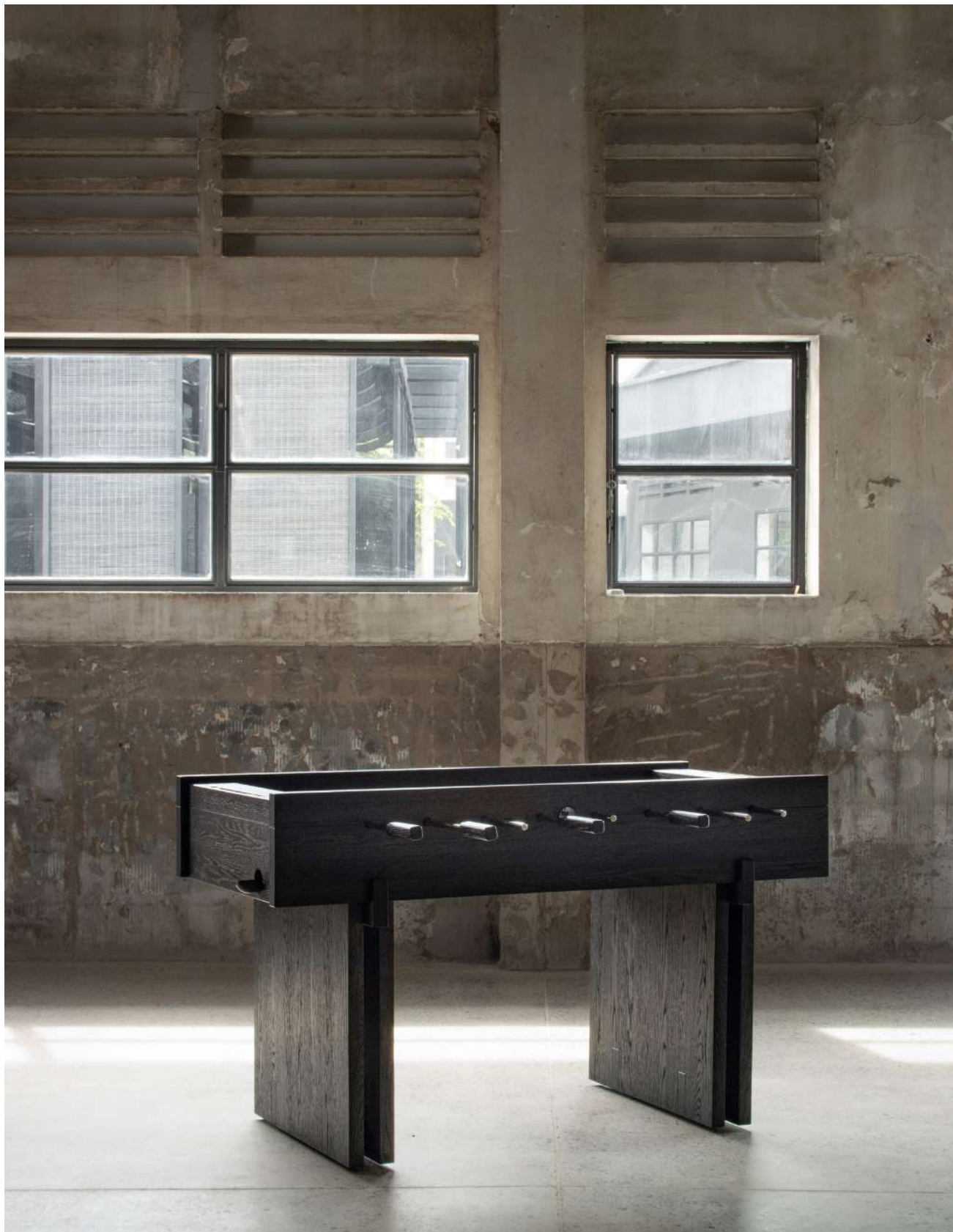



FOOSBALL TABLE



The design employs the fine skills of our woodworking craftsmen to create a sculpturally shaped table outfitted with characterful details. Its distinct frame is crafted from solid oak, with a concrete playing surface to ensure quality game time, while the steel foos-men take on a refined form with sculpted headwear inspired by Vietnamese traditional hats.

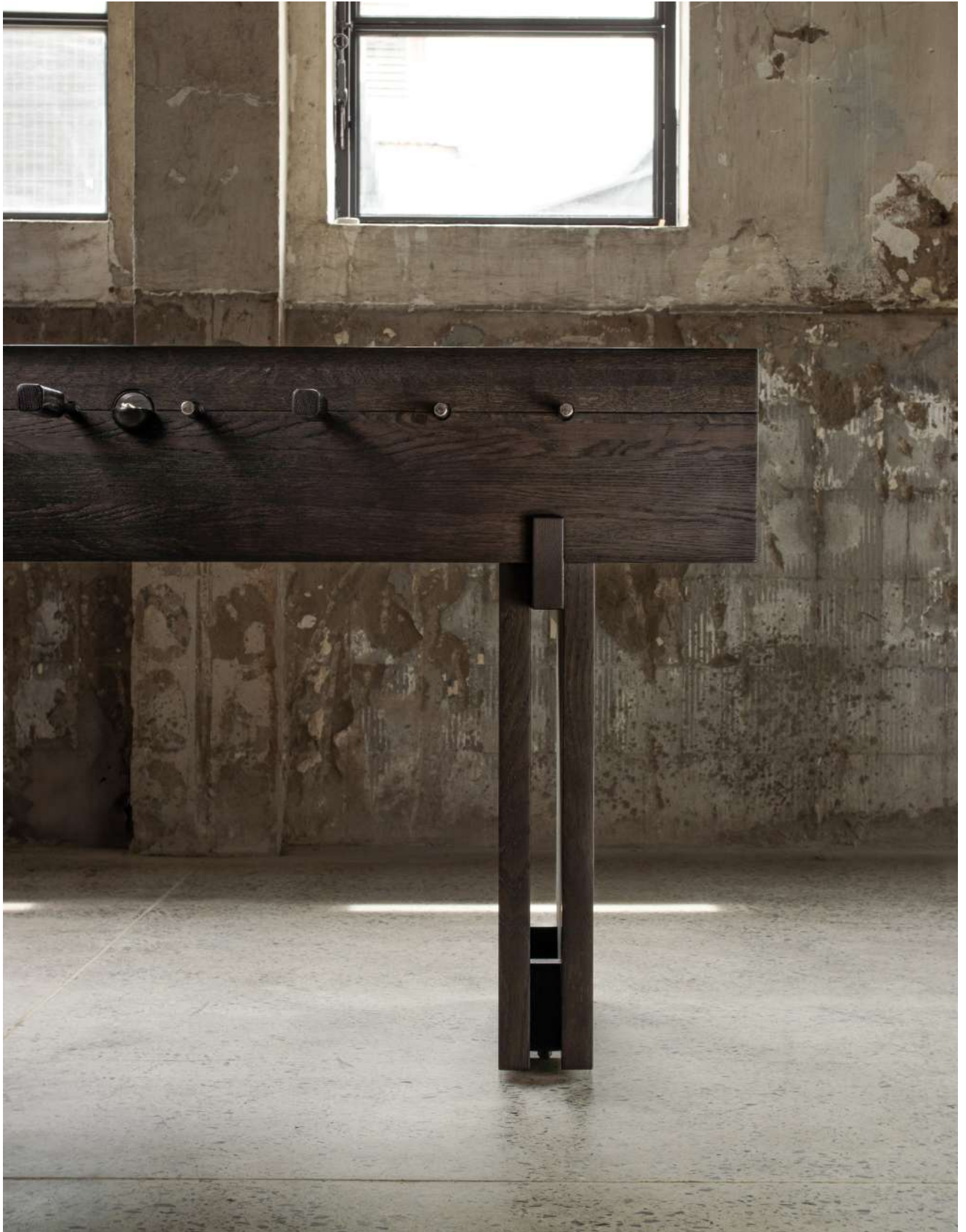





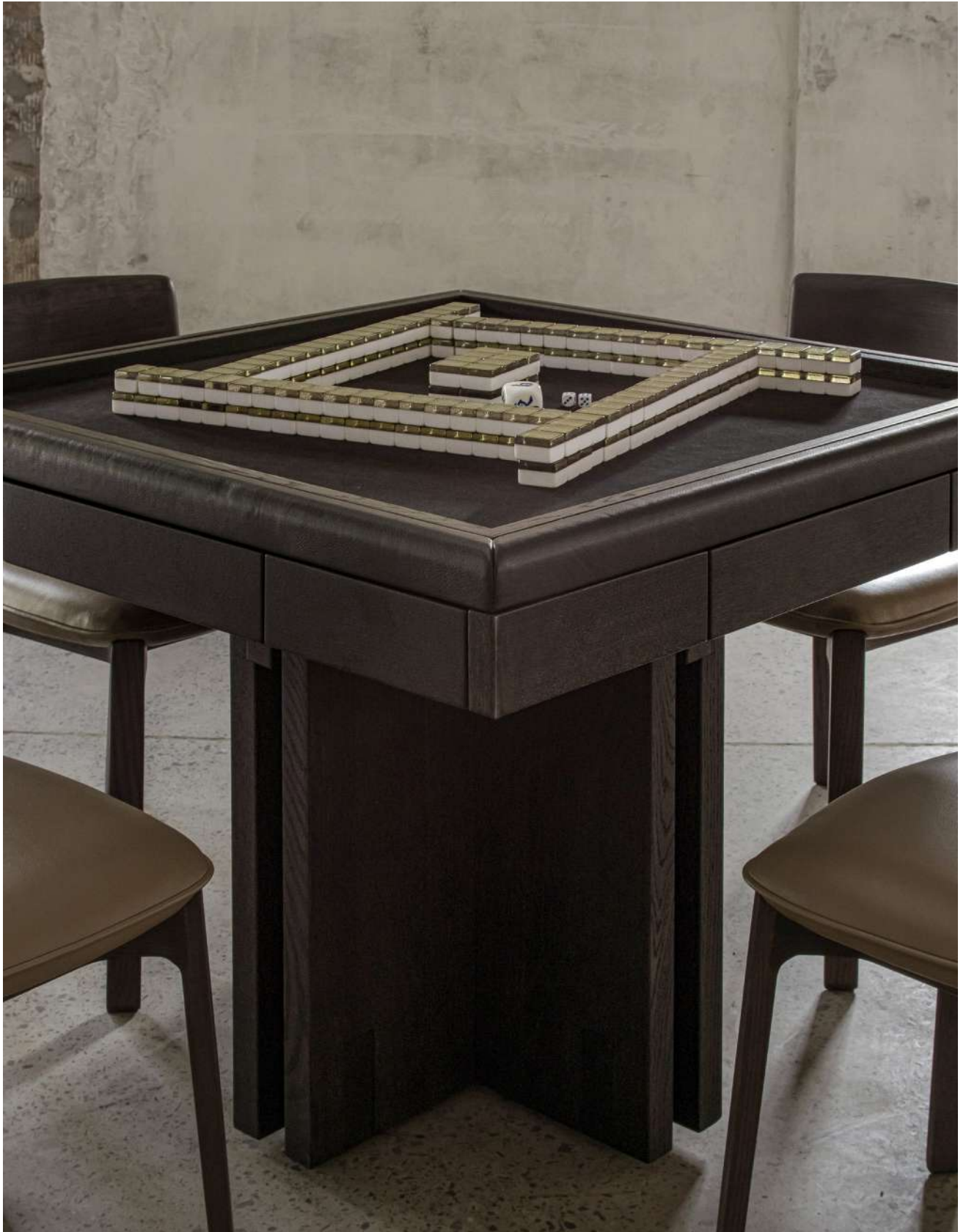

MAHJONG TABLE



Anchored in precision, the table incorporates practical features that define its depth and elegance. The softened edges are arrayed in leather, providing comfort for long, engaging play. The felt-lined surface assumes a monochromatic palette that accentuates its unifying tactility. Drawers for game pieces and drink placement add to its all-encompassing functionality.

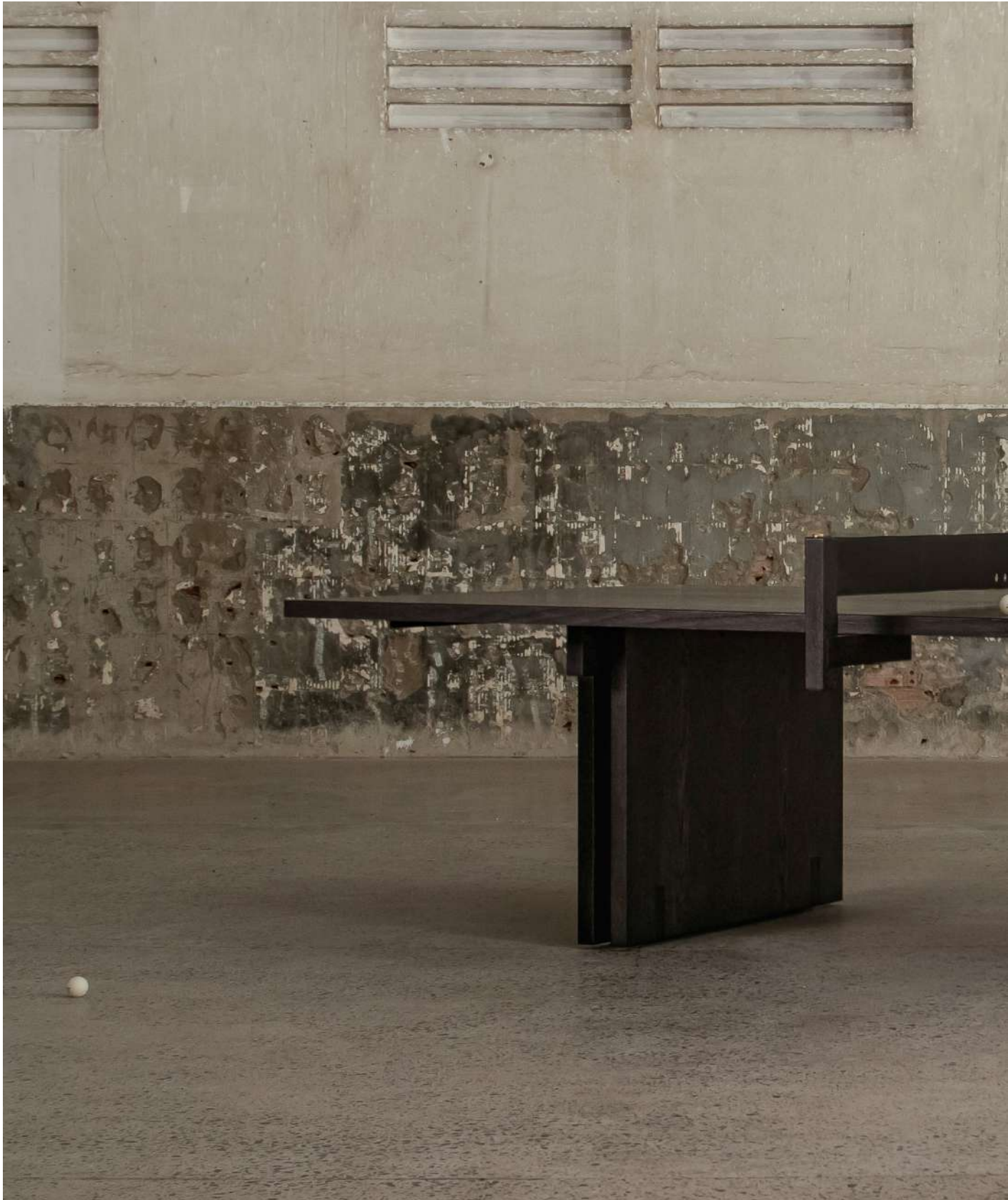





PING PONG TABLE



Featuring a detachable leather net, it can shift from a game table to a relaxed gathering point for work or leisure. The design blends aesthetic and ease with a sense of pleasing symmetry imbued within its clean-lined, structured oak frame. Well-crafted joinery enhances the table's material modernity.







POKER TABLE



The table's well-rounded charm is derived from a balance between volume, texture and style. Its singular structure is crafted from solid oak. The tabletop's edges are overlaid with high-quality leather, while its playing surface is covered with felt fabric. These hands-on detailing adheres to a harmoniously restrained palette, and enriches the table's sophistication.







SHUFFLEBOARD TABLE



The table is a statement in robust simplicity and structural clarity. An oak board varnished with lacquer coating delivers exacting performance, with the landing surface outfitted in hand-stitched leather. Climatic adjusters are integrated underneath the tabletop to accommodate different levels of game for both casual and competitive players.





STYLE INDEX

The drawings refer to the compositions as shown in the pictures. For further information on availability on sizes, we kindly ask you to get in touch with our stores.

DINH

- Oak frame / Leather

Foosball Table
4007

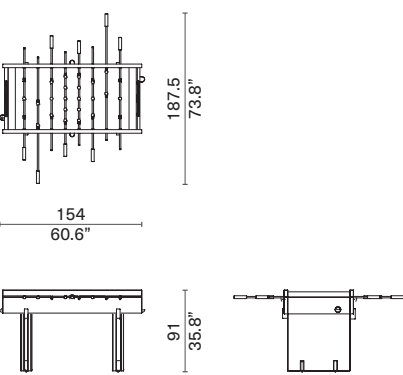

Mahjong Table
4009

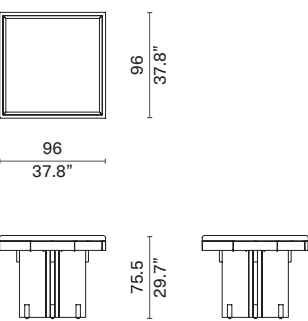

Ping Pong Table
4008

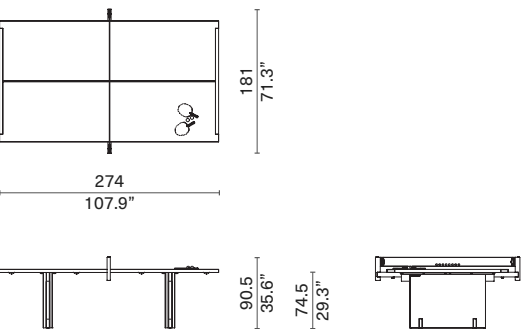

Poker Table
4010

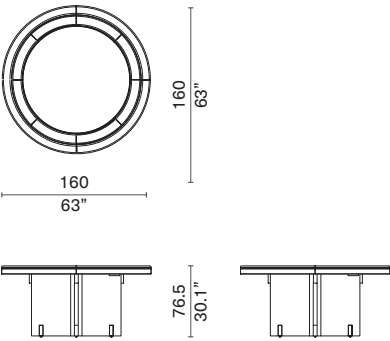

Shuffleboard Table - Small
4006-SML

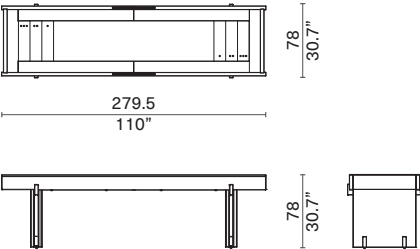

Shuffleboard Table - Large
4006-LAG

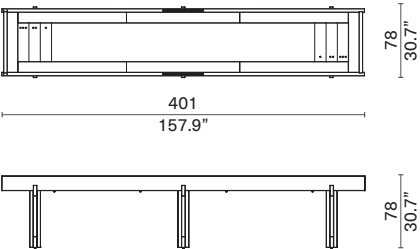

LODGE	Lounge Chair	87	KNOT	Dining Table	151
	Ottoman	90		Dining Chair	157
	Dining Chair	165	AMES	Dining Chair	159
	Bag Holder	90		Bar/ Counter Chair	162
LIMEN	Coffee Table	93	FAIFO	Dining Table	167
	Night Table	181			
	Console	93	VICUNA	Dining Chair	171
JOSS	Sofa System	103			
	Bed	189	ODETTE	Dining Table	175
STILT				Console	235
	Sofa System	113		Bench	173
	Lounge Chair	109	ASSEMBLY		
	Ottoman	111		Dining Chair	195
	Chaise Lounge	115			
	Table	114	DRIFT	Desk	198
INUMBRA	Bed	183		Cabinet	198
				Shelving	198
	Wall Mount Shelving	123	TOTE	Credenza	199
	Single Post	86		Dresser	201
COLLETTE	Floor to Ceiling	119		Tallboy	202
				Small Cabinet	201
	Lounge Chair	127	OBJECTS	Chess Set	205
	Dining Chair	149		Babele Tray	209
LOLA	Bar / Counter / Stool	132		Pipe Vase	210
	Bar / Counter Chair	131			
GUI	Lounge Chair	138			
	Sofa 2-Seater	137			
HIDA					
	Coffee Table	139			
TORUS	Lounge Chair	141			
	Dining Chair	143			
	Sofa 2-Seater	144			
	Bar / Counter Chair	144			



BAGUA SOFA 2-SEATER
Tara Quarzt
Dark Seared Oak

JOSS SOFA & TABLE
Tara Quarzt
Dark Seared Oak

LIMEN COFFEE TABLE
Dark Seared Oak



LODGE LOUNGE & OTTOMAN
Amos Cognac Leather
Raw Oak

LODGE BAG HOLDER
Amos Cognac Leather
Raw Oak

INUMBRA SINGLE POST
Ebonized Oak
Antique Nickel



LODGE

*Designed by
Jean-Marie Massaud*

An art de vivre, the Lodge collection is a meeting of the two complementary yet demanding worlds of Massaud and District Eight; it is one of ease and sophistication met with lasting timelessness. Inspired by the concept of travel and storied voyages to Việt Nam, the Lodge collection features a series of expertly crafted folding chairs, stools, and bag holders.

"EASY + CHIC X LIGHT + ROBUST X TRENDY + EVERGREEN."

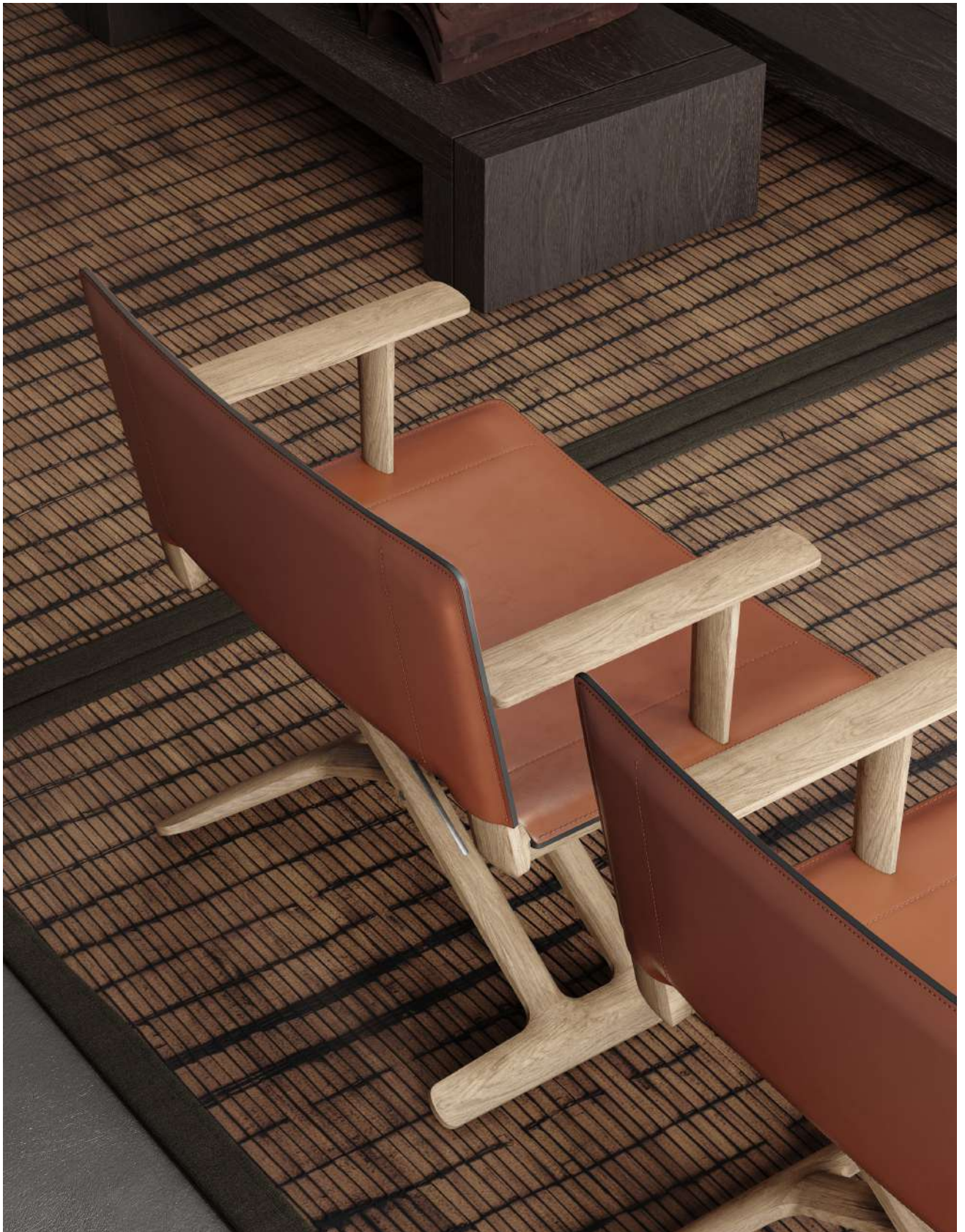









LIMEN

*Designed by
studioutte*



The Limen collection, designed by studioutte for District Eight, features a family of tables based on a portal shape reduced to its purest form. Each piece is crafted from padouk or oak with inlays in blackened steel.

"The collection is an homage to a radical timeless elegance, suspended between Eastern influences and a minimalist approach. It aspires to silently enter the most intimate domestic spaces as if it had always been there."





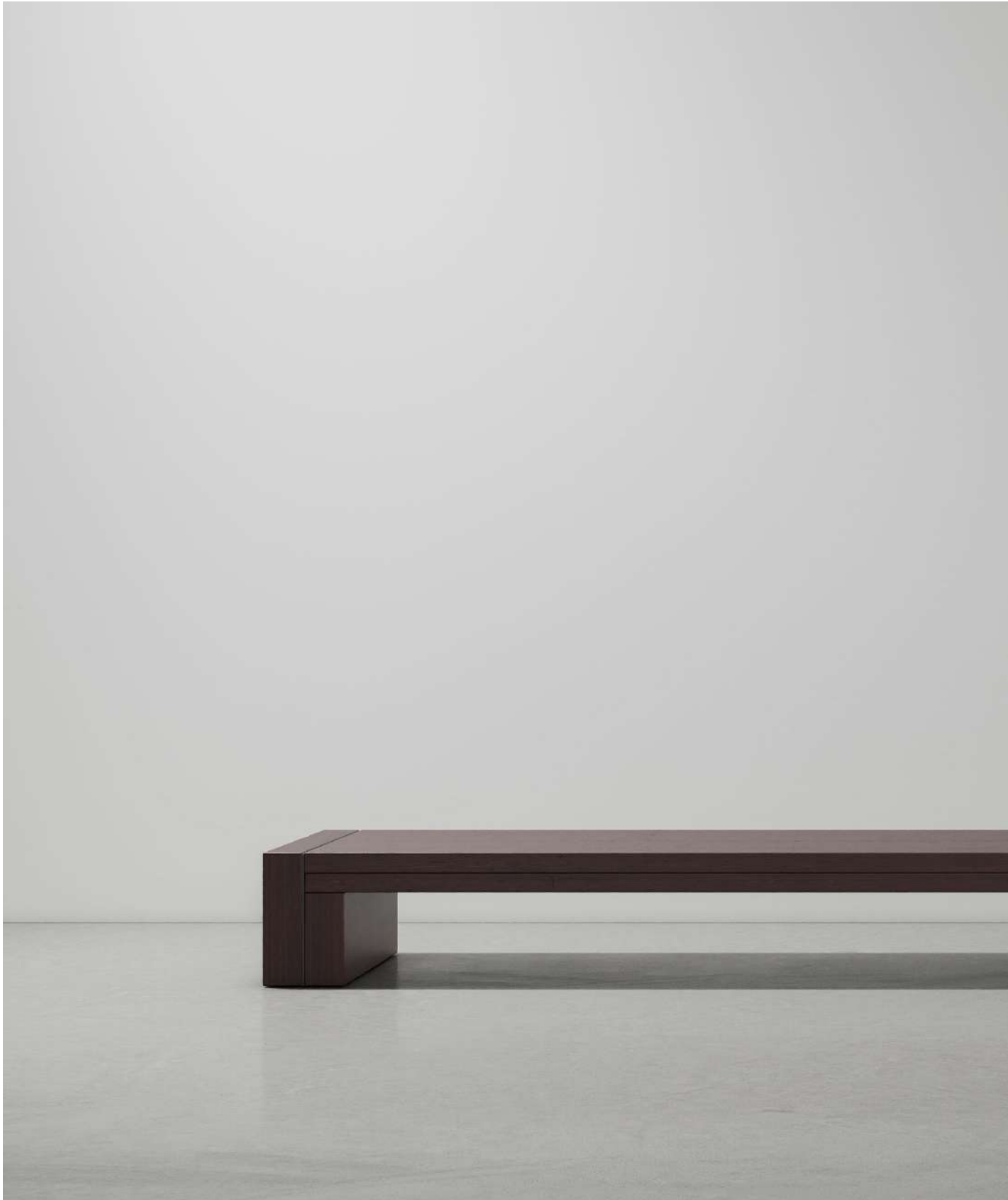

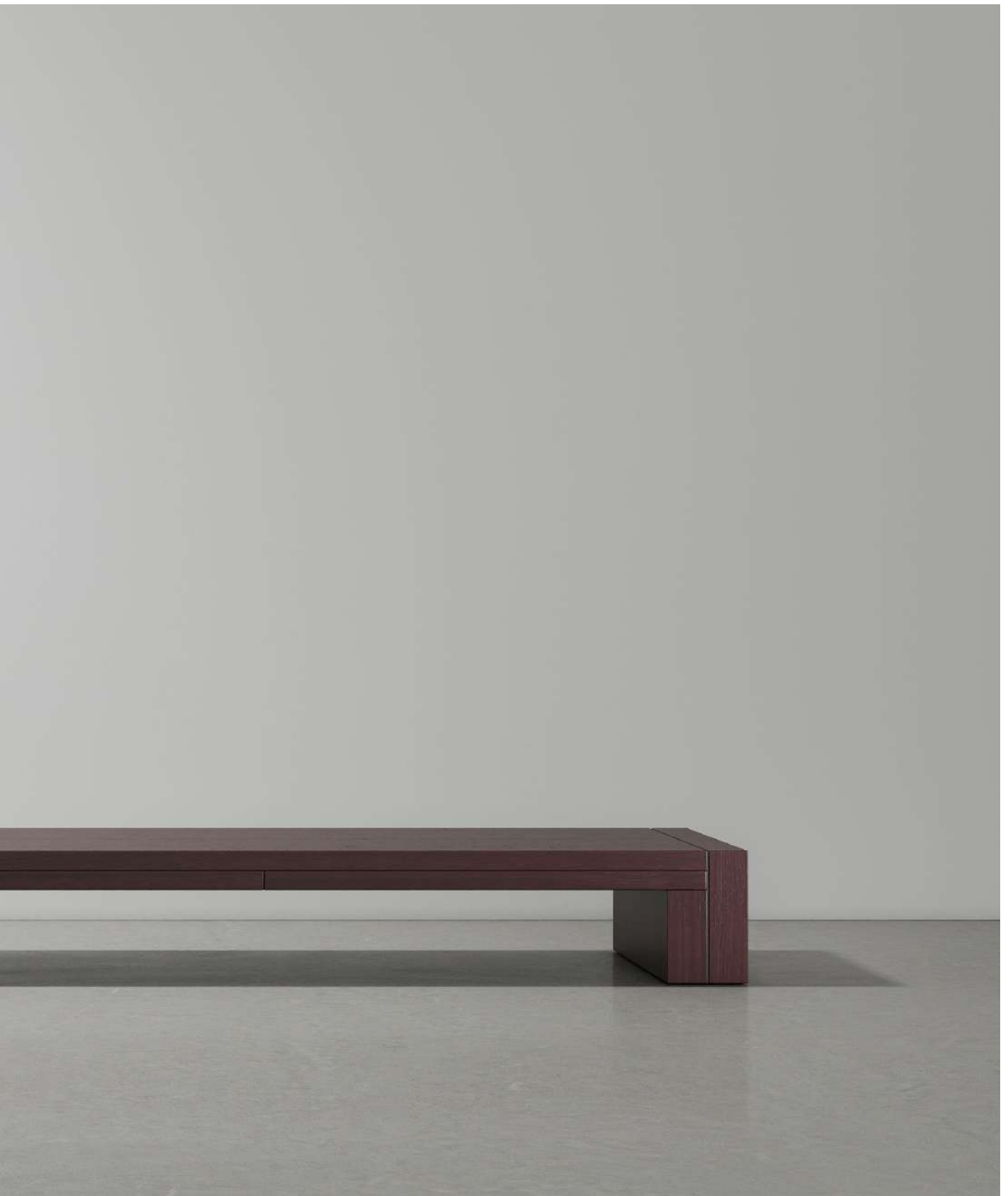







JOSS SOFA & TABLE
Neos Pearl
Ebonized Oak

STILT LOUNGE CHAIR & SOFA
Neos Bark
Omari Ink Black Leather / *Ebonized Oak*
Antique Nickel

NEN CABINET
Ebonized Oak
Antique Nickel



STILT CHAISE LOUNGE

Noah Ivory

Omari Sepia Leather

/

Begie Oak

Antique Nickel

STILT COFFEE ROUND TABLE

Begie Oak

Antique Nickel



JOSS

*Designed by
Toan Nguyen*

Joss is a clear illustration of the fact that, in design, the quest for simplicity is the result of a complex journey. Creating a monolithic sofa characterized by exceptional seating comfort and coverings that emphasize the roundness of the volumes while maintaining a clear definition of the edges through particular attention to the seams is challenging.

Joss oak bases, whose natural tones are the result of an ingenious process developed by District Eight, are characterized by an upper curvature, a declared reference to ancestral elements of Southeast Asian architecture.

**"IF JOSS CONCEALS DETAILS THAT ATTRACT THE
EYE AND THE HAND WITHOUT OSTENTATION, IT
IS HARMONY AND SERENITY THAT PREVAIL."**









STILT

*Designed by
Toan Nguyen*

Its conscious and no-frills design underlines District Eight's distinctive vision to articulate Vietnamese storied craftsmanship from a contemporary perspective - one that's inspired by European ingenuity, and resonates with people all over the world.

With the sofa and Lounge chair, separate back and seat cushions gently slot into a slender wood platform that comes in either leather or fabric upholstery. Together they're supported by a sinuous frame, whose seemingly simple structure pays homage to traditional stilt houses found in Northern and Central Việt Nam.

That bearing base consists of elegant wood beams and steel bars, laboriously worked on and sturdily unified by recessed joints of discerning precision. Such details also pertain to the collection's table set, providing support for its solid oak top.

A new interpretation of District Eight's signature forms and materials, the collection eloquently captures the beauty of design and the mood of modern-day living in an ever-changing world.

**"STILT IS THE RESULT OF A QUEST FOR
HARMONY IN CONTRAST."**







A delicate balance between understated clarity and intuitive elegance, the Stilt Lounge chair is outfitted with enveloping cushions that relax the body along the line of an ergonomically reclined platform, while providing tactile comfort thanks to their minute construction.

The Stilt Ottoman is drawn from the collection's sense of harmony and naturalness, brings in a pleasing complement to Stilt's extensive lineup, and accommodates space for everyday rest and leisure.







Part of a broader collection designed by Toan Nguyen for District Eight, the Stilt Chaise Lounge is an expansion on the charm and ingenuity that Stilt is beloved for. Its steel and oak base is signature of the collection, alluding to traditional stilt houses in Southeast Asia.



The reclining frame, crafted from oak and upholstered in leather or fabric, is ergonomically contoured, and attached with a form-fitting layer of foam to provide comfort. Also comes with an adjustable headrest, the Stilt Chaise Lounge makes a calmed cocoon for ultimate relaxation in your interior settings.



INUMBRA SHELVING
Dark Seared Oak
Antique Copper

JOSS SOFA
Tara Quartz
Ebonized Oak

TORUS COFFEE TABLE
Burned Fir
Athena Grey Marble

LODGE LOUNGE CHAIR
Amos Light Leather
Ebonized Oak



LODGE BAG HOLDER
Amos Light Leather
Ebonized Oak

NEN DRESSER
Ebonized Oak
Antique Nickel

TONKIN CONSOLE - LOW
Dark Seared Oak
Antique Copper



INUMBRA

*Designed by
Michele De Lucchi*

Inumbra is a collaborative study between Michele De Lucchi and District Eight, resulting in reinvention of modular components that build a shelving system. From sculptural stature to discreet details, Inumbra captures the Italian architect and designer's unique expressions, while highlighting District Eight's technical capability in pared-back utility and clarifying aesthetic.

The structural elements are as easily assembled as seamlessly adjustable to varying needs and tastes. With unexpected rhythm and compositions, Inumbra poses a refreshing expression that casts new light on a long-standing staple.

" INUMBRA IS AN ARCHITECTURAL OBJECT OF IMPOSING PRESENCE. IT RESPONDS TO THE FLUIDITY OF BEHAVIORS IN AN INCREASINGLY INTERCONNECTED WORLD, WHERE THE LINES BETWEEN PRIVATE AND PUBLIC SPACES ARE BLURRED AND INFLUENCING EACH OTHER."

PROJECTING ELEMENTS



End-caps are designed with built-in magnets that allow easy attachment to shelves.



The post's footer can be adjusted up to 7mm.

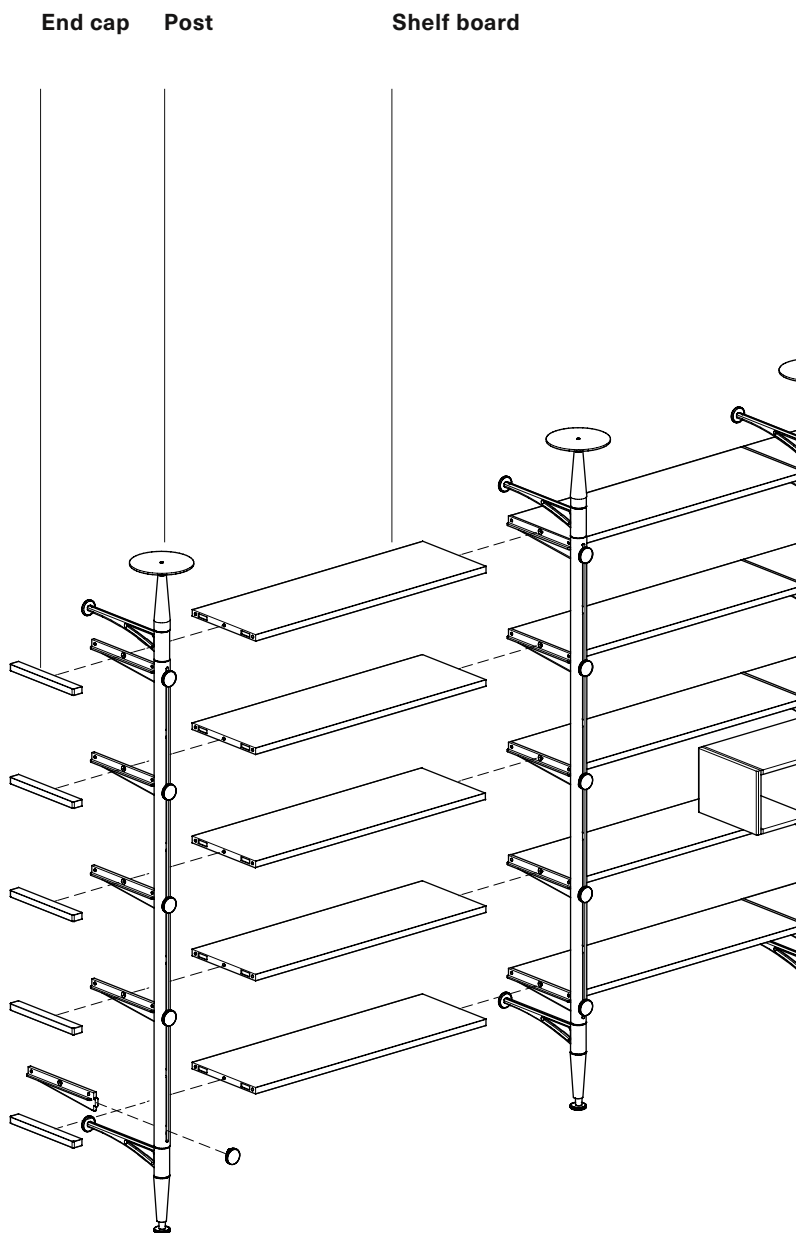

Cabinet with drawer

3007-W1DR

Cabinet

3007-CABN

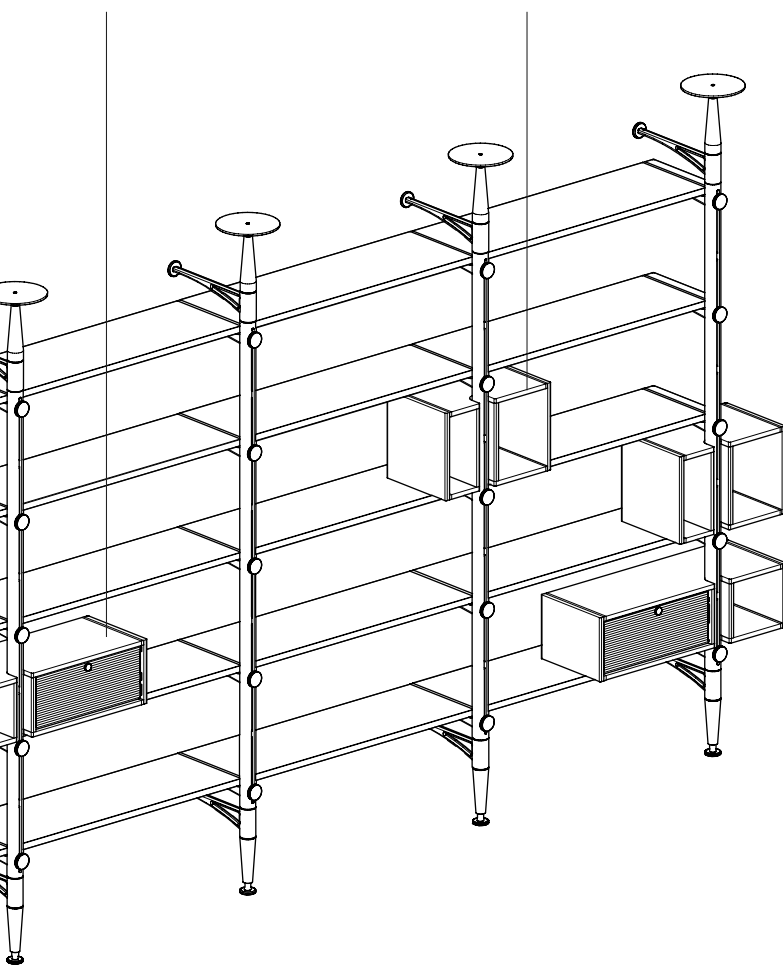

The brackets come in fitting options that allow flexible spacing between shelves. Inumbra can accommodate a wide range of displays, including books and folders, objects and rarities, among many other collections.

Cabinet and cabinet with drawer are reversible and fixed to any desired place on the shelving system.

Inumbra can be configured to specific needs. From variable width and height to positional cabinets, units can be added over time. It is precisely the multiple combinations and different positions of the elements on the structure that give it an unexpected rhythm, while still maintaining a motif of linearity and utilitarian usage.







STILT SOFA
Noah Wheat
Omari Sepia Leather

/ *Dark Seared Oak*
Antique Copper

LIMEN COFFEE TABLE
Dark Seared Oak

LOLA SOFA 2-SEATER
Noah Wheat
Dark Seared Oak



GUI COFFEE TABLE
Black Lacquer

COLLETTE LOUNGE CHAIR
*Echo Thunder
Charcoal Ash*

LIMEN CONSOLE
Dark Seared Oak



COLLETTE

*Designed by
Adam Goodrum*

Through a harmony of verticals and curves, the Collette chair offers an abstract reference to the Vietnamese traditional script, and a love letter to the craftsmanship of timber. The design's sweeping backrest forms a collar that's instantly distinctive and inviting. Extended to swooping ridges of the armrests and their rounded ends, the frame provides ample support for ease and comfort. Elegant yet robust, Collette comes in with a wide range of upholstery for its seat cushion, lending the collection a level of formality and sophistication in any space it finds a home in.

**"A METAPHORICAL LOVE LETTER TO TIMBER
CRAFTSMANSHIP."**















LOLA LOUNGE & SOFA 2-SEATER
Noah Wheat
Ebonized Oak

LIMEN COFFEE TABLE
Ebonized Oak
Antique Nickel

INUMBRA SHELF
Ebonized Oak
Antique Nickel

GUI COFFEE TABLE
Black Lacquer



STILT SOFA

Neos Bark

Omari Ink Blak Leather

/

Dark Seared Oak

Antique Copper

LIMEN CONSOLE

Ebonized Oak

Antique Nickel



LOLA

Lola tells a simple story of curves and lines - the geometry of amplexness. To achieve a clean look with encompassing comfort, Lola upholstered backrest is elevated to wrap elegantly around a generous seating cushion by a solid timber frame. This welcoming design is completed with pipping details that neatly trace and define the upholstery profile. Lola envelopes the sitter in comfort, encouraging relaxation and engagement.



GUI



The GUI collection embodies the resilience and spirit of Vietnam's highlands through its interpretation of the traditional Gùi – a woven back-basket. Each table, available in three sizes, mirrors the Gùi's shape - a round top symbolizing the sky and a square base grounding it to the earth, reflecting a cycle where the sky nourishes the land.

The collection's lacquered finish nods to East Asian artistry, celebrating centuries-old techniques while bringing a touch of contemporary sophistication. This intersection of culture and modern design gives the GUI tables their unique narrative depth and versatility for various living spaces.

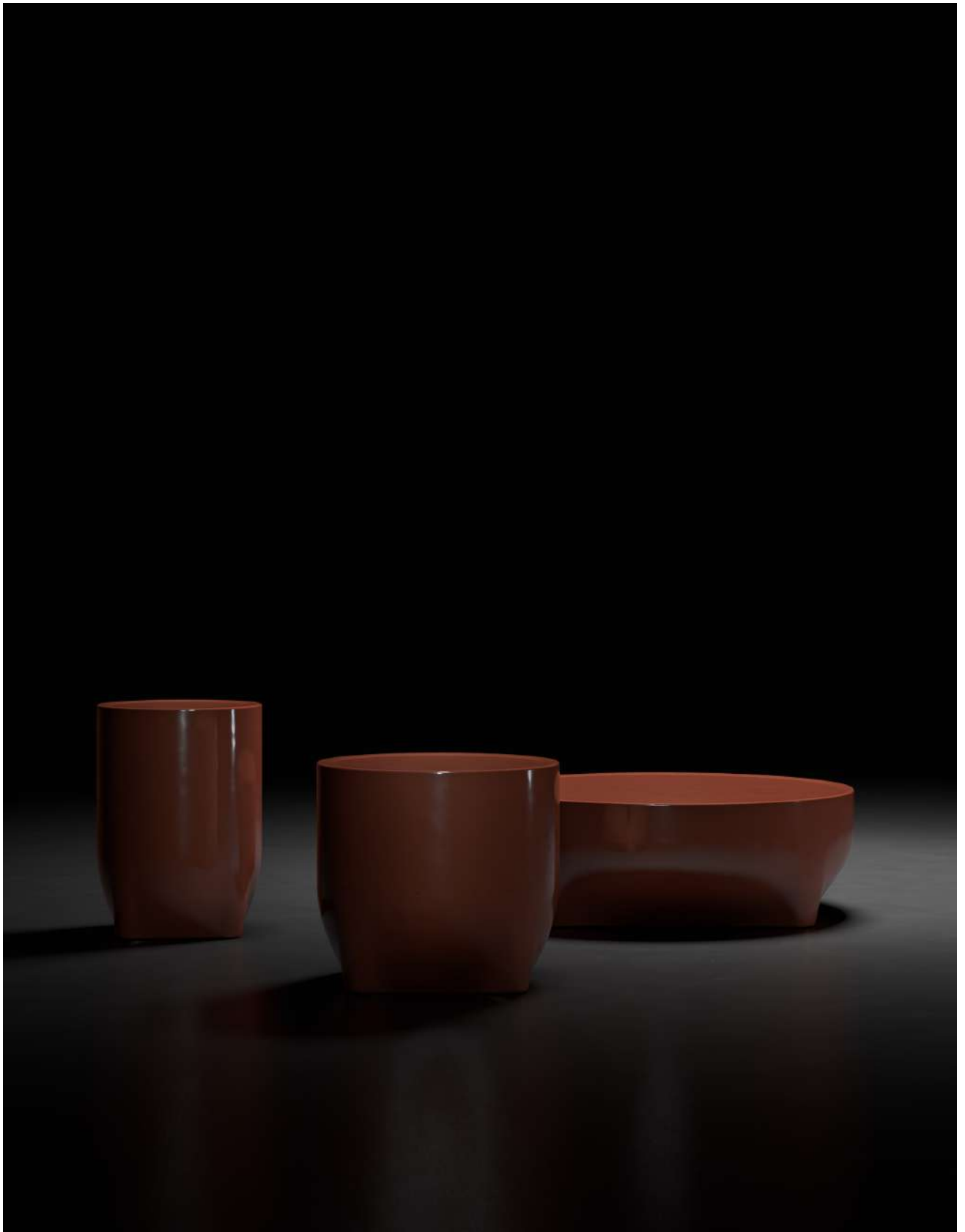

HIDA



Hida Collection offers a seating lineup that embodies effortless style and comfort. With its upholstered seat resting elegantly on sturdy, rectangular-shaped solid wooden legs, the collection presents a reliable and visually pleasing structure.

The option to feature two types of upholstery allows for intriguing texture configurations, further complemented by the practical leather strap on the back. Hida strikes a balance between aesthetic form and versatile practicality.



HIDA LOUNGE CHAIR
Echo Thunder
Smoked Oak

TORUS COFFEE TABLE
Burned Fir
Athena Grey Marble.







TORUS



Torus, a collection of side and coffee tables, blends contrasting textures and materials to achieve a sense of unity and sculptural beauty. Its design creates a well-proportioned structure, with a cylindrical base made of natural marble and steel, jointly balanced by a round timber top, hand-finished with a unique grain texture. Simple yet singular, Torus can complement a diverse set of styles in contemporary settings.







COLLETTE CHAIR WITH ARMS
Echo Thunder
Charcoal Ash

COLLETTE CHAIR
Mohair Brick
Charcoal Ash

COLLETTE STOOL
Echo Thunder
Charcoal Ash



KNOT DINING TABLE
Ebonized Oak



KNOT



Knot finds inspiration from the intricate weaving patterns in Asian traditional handicrafts, and reimagines them as beguiling details for solid oak tables. Through masterful woodworking, the legs are interlaced in a visual rhythm that evokes a sense of lightness and fluidity. The result is a well-balanced structure that can lend original appeal to most contemporary spaces.

Available in round or rectangular variants, they offer versatile finish options and sizes to suit your personal preference.









AMES CHAIR
Sila Fog
Smoked Oak

KNOT CHAIR
Sila Fog
Dark Seared Oak

KNOT ROUND DINING TABLE
Dark Seared Oak

DRIFT DROP DOWN CABINET
& WALL SHELIVING
Dark Seared Oak



Drawing from the timeless art of weaving, the Knot Dining Chair embodies strength and fluidity. Influenced by the intricate patterns and durability of knotted structures, it features a solid oak frame and a curvilinear backrest, echoing the natural tension and release found in knotted forms. The design provides both aesthetic appeal and supportive comfort, reimagining traditional techniques for contemporary dining spaces.





AMES



Ames is a collection of bar, counter and dining chairs. Laid-back, almost egg-like in shape, and fanning out towards the seating cushion on both sides, the design's backrest is constructed from wood frame then fully upholstered in fabric or leather. In place of hidden joints, the chairs' tapered oak legs are extended upwards onto seating cushions and backrests, affixed with brass details.











LODGE CHAIR
Amos Light Leather
Ebonized Oak

FAIFO DINING TABLE
Light Fir





FAIFO



Faifo is dedicated to gatherings and conviviality surrounding traditional dining tables in Asia. Available in two shapes – round and rectangular, the design features triple or quadruple wings of legs that call for flexible seating arrangements. The largest round variant comes with a Lady Susan made of natural marble. Its hand-finished treatment of timber brings in textural refinement, spotlighting the table's geometric harmony and monolithic silhouette.



VICUNA CHAIR
Noah Wheat
Ebonized Oak

FAIFO ROUND DINING TABLE
WITH LAZY SUSAN
Burned Fir

TOTE TALLBOY
Omari Sepia Leather
Smoked Oak





VICUNA



The Vicuna dining chair draws inspiration from its namesake – the wild animal native to the high alpine areas of the Andes. Tranquil in form and comfortable to sit, it features a soft upholstered seat in a wide range of fabrics. The lean, elegant frame comes in our signature oak finishes. Brass accents on the curved backrest and tapered legs add more visual depth to this stylistic design.



HIDA CHAIR WITH ARMS

Neos Pearl

Omari Sepia Leather

/

Dark Seared Oak

HIDA CHAIR

Neos Pearl

Dark Seared Oak



ODETTE DINING TABLE
Dry Smoked Oak

ODETTE BENCH
Dry Smoked Oak

TOTE CREDENZA
*Omari Sepia Leather
Smoked Oak*



ODETTE

Odette Collection draws inspiration from the enduring structures of Eastern architecture and objects, offering an appreciation for both cultural heritage and lasting craftsmanship. Crafted entirely from solid wood, the legs feature hand-finished convex and concave details, creating a visual illusion timber jostling against one another. Reinforced with a supporting beam, the traditional trapezoid-shaped legs provide a strong and dependable foundation, while other timber details give Odette a striking resemblance to a pagoda's gate.











STILT BED & BENCH

Neos Bark

Dark Seared Oak

/

Antique Nickel

LIMEN NIGHT TABLE

Padouk



TOTE DRESSER
Omari Putty Leather
Dry Smoked Oak

LOLA LOUNGE
Noah Bark
Dark Seared Oak



STILT

BED



The Stilt Bed with its minimal look was designed to maximize relaxing comfort as well as deliver intuitive elegance, projecting the idea of an embrace, a haven. The tailoring finishes and finely crafted steel elements at the back transform the Stilt Bed into a refined centerpiece in solitary when placed in the middle of the room.







JOSS BED
Echo Thunder
Smoked Oak

LODGE OTTOMAN
Amos Light Leather
Raw Oak

LODGE BAG HOLDER
Amos Light Leather
Raw Oak

INUMBRA WALL SHELVING
Raw Oak
Antique Nickel



BAGUA LOUNGE
Neos Bark
Smoked Oak



JOSS

BED



With generous foam for unparalleled comfort and seams of aesthetic precision that highlight the bed's silhouette, the Joss Bed symbolizes the elegance of simplicity. Its solid wood base features a subtle curvature inspired by the roofs of Southeast Asian temples, adding a touch of architecture to its contemporary design.







STILT CHAISE LOUNGE

Neos Pearl

Omari Putty Leather

/

Beige Oak

Antique Nickel

LIMEN COFFEE TABLE

Ebonized Oak

DRIFT DESK

Ebonized Oak



DRIFT CABINET AND DRAWER
Ebonized Oak
Antique Nickel

DRIFT SHELVING
Ebonized Oak
Antique Nickel

ASSEMBLY CHAIR WITH ARMS
Mohair Sand
Dry Smoked Oak

ASSEMBLY



The Assembly dining chair is built on sculptural oak frames with tapered legs, offering comfortable and durable leather seats. The backrest is crafted with cast aluminium in the mold of wood grain texture, leaning into our signature interplay of materials and techniques. Assembly is available with or without armrests, along with various wood and leather finishes for your personalization.





DRIFT



Drift is a collection of wall-mounted desks, shelves, cabinets and drawers that create the perfect storage system for home and office. These fit-for-purpose modules can be sized, combined and configured according to your exact need and space. Every Drift module features a hand-polished steel top, offering tactile contrast with their sturdy oak frames and inviting tasteful arrangement of your everyday objects. Cabinets and drawers are fitted with brass pulls for gratifying hand feel and seamless use.

TOTE



A collection of cabinets, credenzas, dressers and tallboys, Tote honors the simple pleasure of personal keepsakes, collected curiosities, and organized routines. Streamlined in form and function, the collection's standard builds with drawers and/or doors are crafted in oak.

Subtlety for details is highlighted upon the evenly contrasted steel legs, while the highlight awaits in Tote's hand-crafted handles – outfitted in high-quality leather, they provide tactile pleasure and warmth upon touch. The collection is a testament to how everydayness can be elevated to edifying revelations.















Modeled on the exacting standards of our beloved furniture, the Chess Set by District Eight combines the sheer beauty of materials with authentic inspirations from Vietnamese court attires of yore, resulting in unique pieces for keeps and magnetic hours of play.

The chessboard is constructed of smoked oak and ash wood, meticulously hand-picked and refined to perfection, and equipped with cylindrical steel legs for weight support and easy pull. Cast in aluminum with brass and black finishing, the stylized pieces are padded with felt to provide sensory comfort for players.



CHESS SET



BABELE



Designed by studioutte, the tray is composed of blackened steel and clean lines. Its monolithic block base anchors a thin square dish that gently slopes down toward the center. Available in two sizes – large and medium, the trays can be stacked on top of one another, resulting in a sculptural arrangement that echoes the tiered structure of Asian pagodas. Babel makes an elegant display for objects and knick-knacks, unfolding versatile styling for contemporary space.

PIPE



The Pipe vase by studioutte is designed to bring design of natural grace to your everyday life. Its cylindrical, softly concave shape draws inspiration from the internodes of bamboo, a traditional craft material and literary symbol in many Asian cultures. Its hand-painted lacquer coating comes in black or oxblood color. Pipe is a simple yet charming decorative piece, a fine accent of relaxed harmony for any living interior.

STYLE INDEX

The drawings refer to the compositions as shown in the pictures. For further information on availability on sizes, we kindly ask you to get in touch with our stores.

COLLETTE

Designed by
Adam Godrum

- Oak or Ash Frame /
Upholstered Seat

Lounge Chair
2020-LGCH

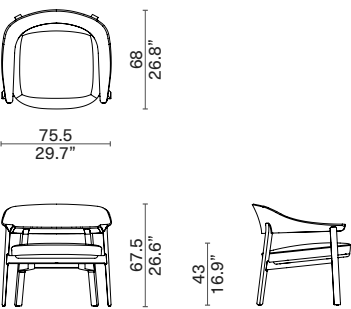

Dining Chair with Arms
2020

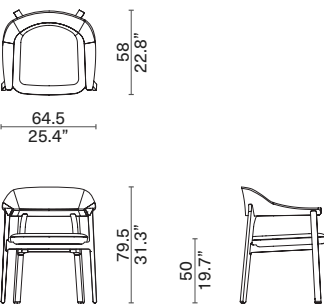

Dining Chair
2020-ALES

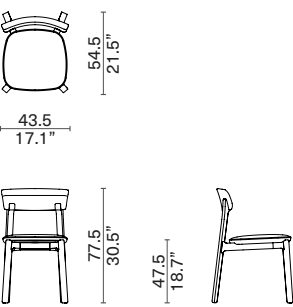

Stool
2020-LOST

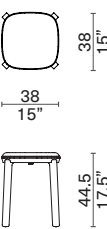

Counter Stool
2020-COST

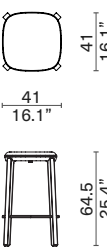

Bar Stool
2020-BAST

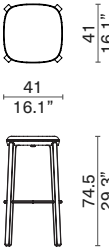

INUMBRA

Designed by
Michele De Lucchi

- Oak Frame / Steel Hardware

Standard - Medium
3007-MED

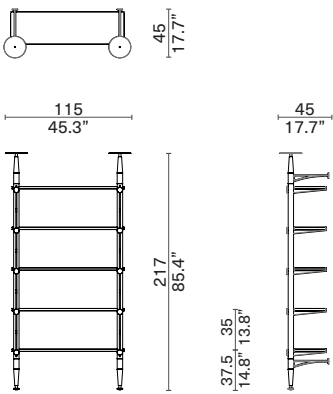

Extension - Medium
3007-EXTS-MED

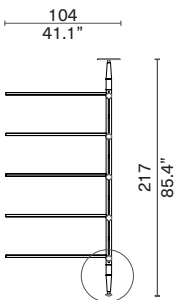

The post's footer can be adjusted up to 0.7 cm (0.27 inch)

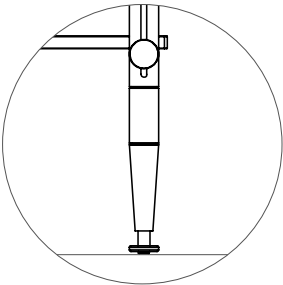

Cabinet
3007-CABN

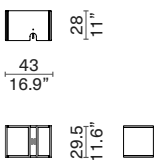

Cabinet with Drawer
3007-W1DR

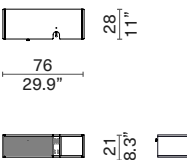

Both cabinets can be displayed to different orientation by rotating the cabinet and changing the hook position.

Cabinet and cabinet with drawer are reversible and fixed to any desired place on the shelving system.

Standard - Large
3007-LAG

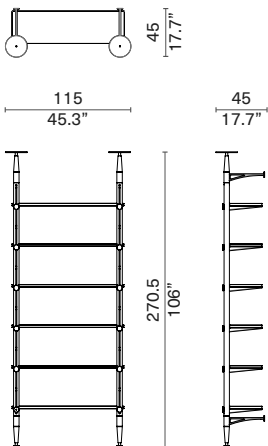

Extension - Large
3007-EXTS-LAG

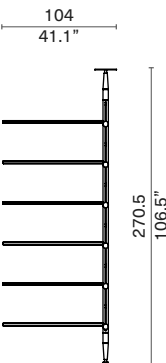

INUMBRA

Designed by
Michele De Lucchi

- Oak Frame / Steel Hardware

Floor To Ceiling - Standard
3009-H1

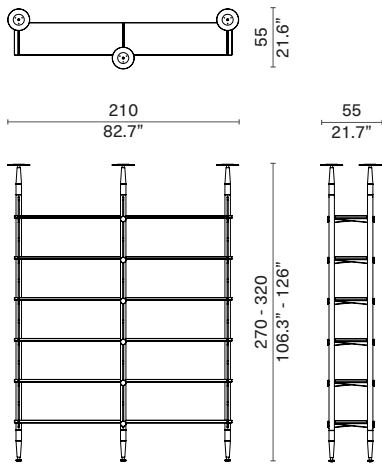

Floor To Ceiling - Extension
3009-EXTS-H1

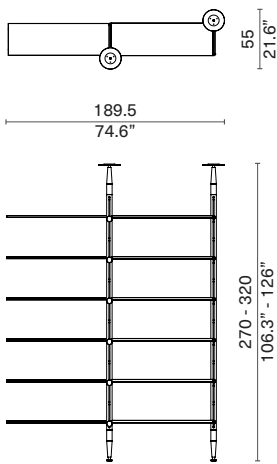

Adapter component to create different heights of Inumbra Floor to ceiling config:	3009-ADAP-H1 / 3009-EXTS-ADAP-H1	H270
	3009-ADAP-H2 / 3009-EXTS-ADAP-H2	H280
	3009-ADAP-H3 / 3009-EXTS-ADAP-H3	H290
	3009-ADAP-H4/ 3009-EXTS-ADAP-H4	H300
	3009-ADAP-H5 / 3009-EXTS-ADAP-H5	H320

Composition in set
3007 / 3007-EXTS x4 / 3007 - ABM x3 / 3007 - W1DR x2

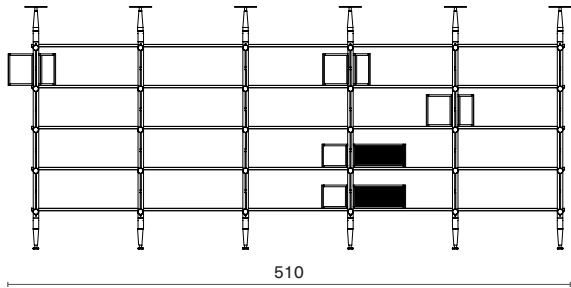

JOSS

Designed by
Toan Nguyen

- Upholstery / Oak base

1-seater Left Arm
2019-M1LA

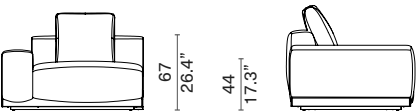
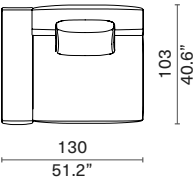

1-seater Right Arm
2019-M1RA

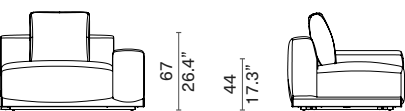
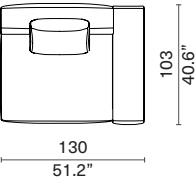

1-seater Armless
2019-ALES

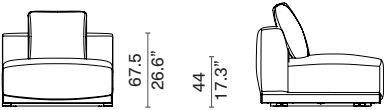
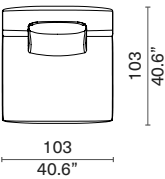

1-seater Corner
2019-M1CN

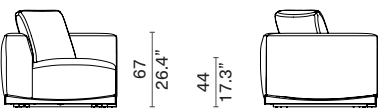
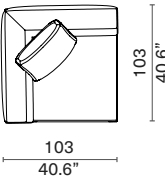

Ottoman
2019-OTTO

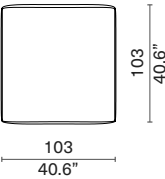
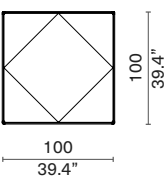

Table
1014



JOSS

Designed by
Toan Nguyen

- Upholstery / Oak base

Daybed Left Arm
2019-LFDB

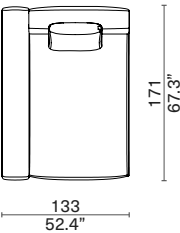

Daybed Right Arm
2019-RGDB

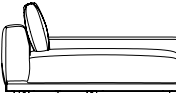
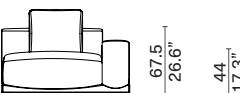
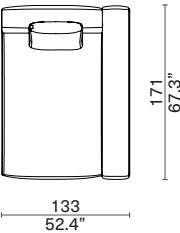

Daybed Armless
2019-DBWO

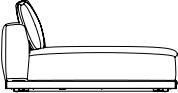
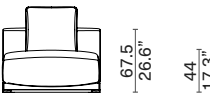
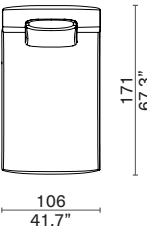

Recommended sets

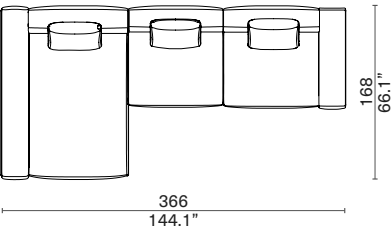
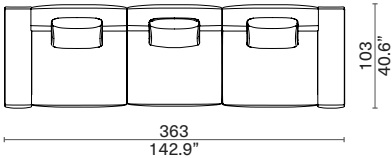
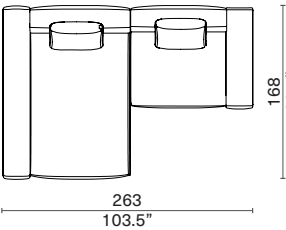
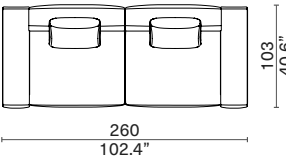

Recommended sets

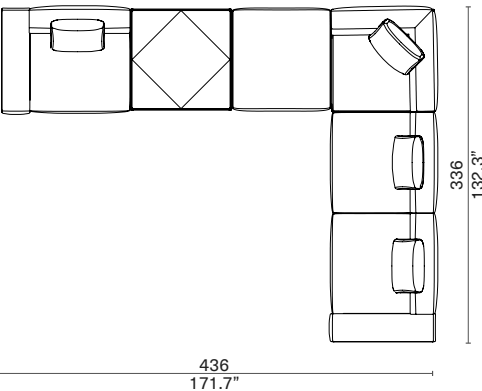
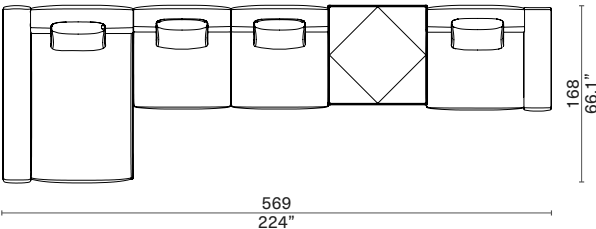
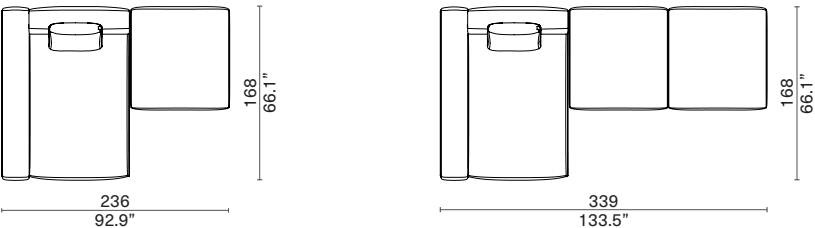
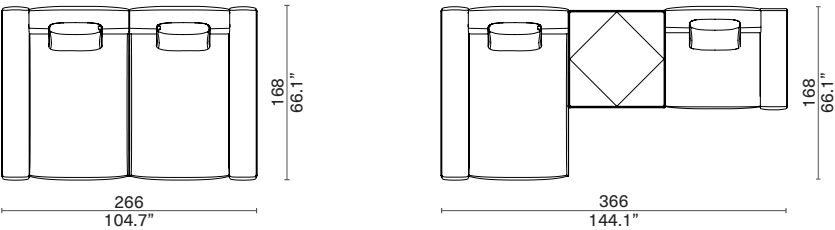

JOSS

Designed by
Toan Nguyen

- Upholstery / Oak base

Bed - King
3021-KIN

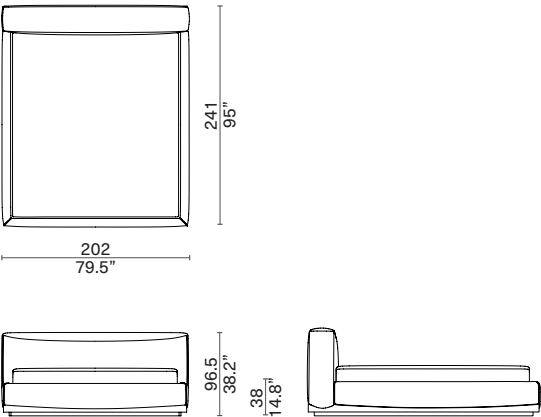

AVAILABLE SIZES	(Frame)			(Mattress)		
King Size	L241	W202	H96.5	L200	W180	Thickness 30
	L94.9"	W79.5"	H38"	L78.7"	W70.9"	Thickness 11.8"
Queen Size	L241	W182	H96.5	L200	W160	Thickness 30
	L94.9"	W71.7"	H38"	L78.7"	W63"	Thickness 11.8"
US King Size	L246	W220	H96	L203	W193	Thickness 30
	L96.9"	W86.6"	H37.8"	L79.9"	W76"	Thickness 11.8"
US Queen Size	L246	W179	H96	L203	W152	Thickness 30
	L96.9"	W70.5"	H37.8"	L79.9"	W59.8"	Thickness 11.8"

Bed Extended Headboard - King
3021-EXBD-KIN

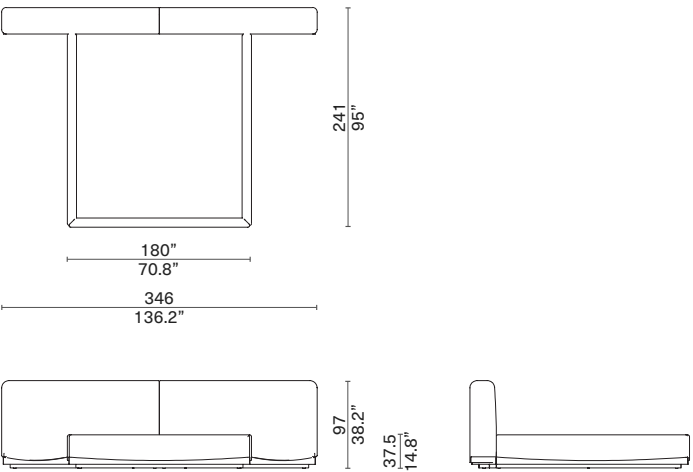

AVAILABLE SIZES	(Frame)			(Mattress)		
King Size	L238.5	W345	H88.5	L200	W180	Thickness 30
	L93.9"	W135.8"	H34.8"	L78.7"	W70.9"	Thickness 11.8"
Queen Size	L238.5	W325	H88.5	L200	W160	Thickness 30
	L93.9"	W128"	H34.8"	L78.7"	W63"	Thickness 11.8"
US King Size	L242	W358	H88.5	L200	W152	Thickness 30
	L95.3"	W140.9"	H34.8"	L78.7"	W63"	Thickness 11.8"
US Queen Size	L242	W317.5	88.5	L203	W152	Thickness 30
	L95.3"	W125"	H34.8"	L79.9"	W59.8"	Thickness 11.8"
Cali King Size	L252	W348	H88.5	L213	W183	Thickness 30
	L99.2"	W137"	H34.8"	L83.9"	W72"	Thickness 11.8"

LODGE

Designed by
Jean-Marie Massaud

- Leather Seat Backrest / Oak
Frame

Lounge Chair
2038-LGCH

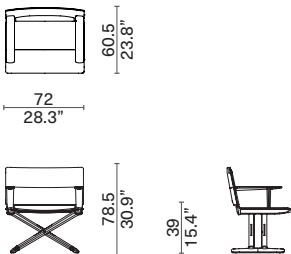

Ottoman
2038-OTTO

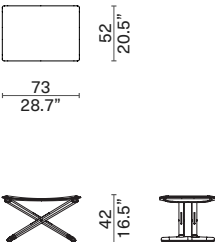

Dining Chair with Arm
2038-AMCH

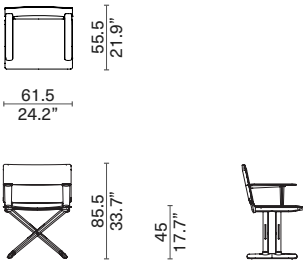

Bag Holder
2038-BAHD

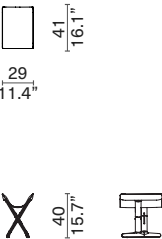

LIMEN

Designed by
studioutte

- Padouk or Oak/ Metal

Rectangular Coffee Table - Medium
1033-RE-MED

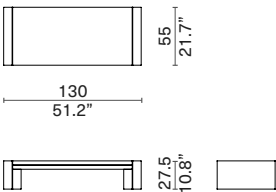

Rectangular Coffee Table - Extra Large
1033-RE-EXL

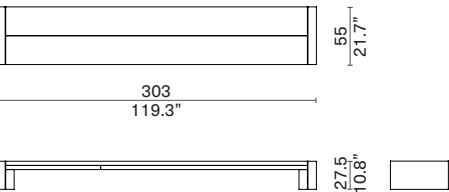

Night Table
1033-NITB-RE

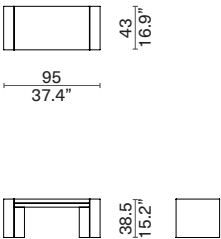

Console
1033-CONS

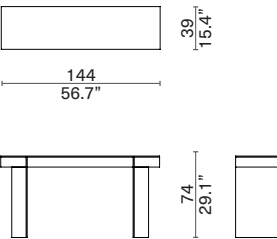

STILT

Designed by
Toan Nguyen

- Oak frame / Steel structure
/ Upholstered headboard &
rails

Lounge Chair
2016-AMCH

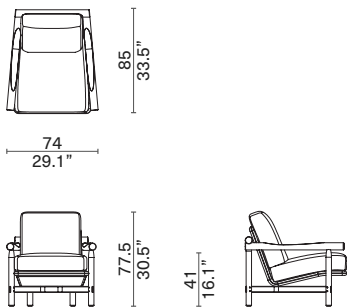

Ottoman
2016-OTTO

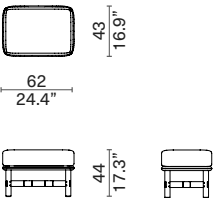

Chaise Lounge
2016-CHLG

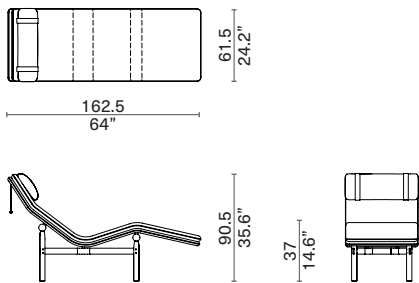

Daybed with Left Arm
2017-LFDB

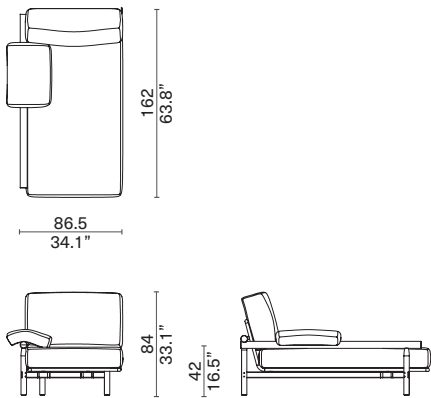

Daybed with Right Arm
2017-RGDB

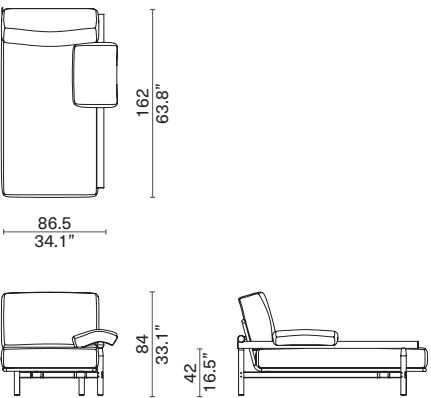

Sofa 2-seater with Left Arm
2016-2SLA

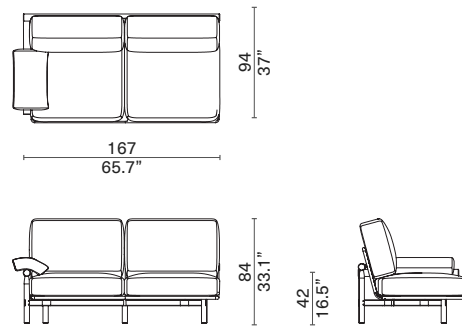

Sofa 2-seater with Right Arm
2016-2SRA

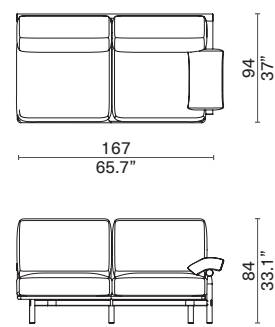

Sofa 2-seater - Medium
2016-2SEA

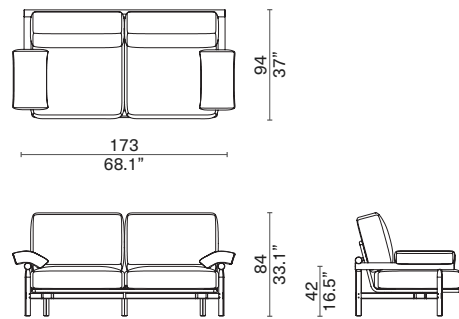

Sofa 2-seater - Large
2016-2SEA-LAG

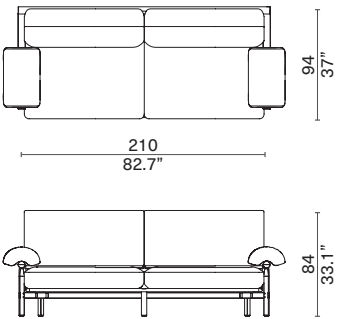

Sofa 2-seater without Arm
2016-2SWO

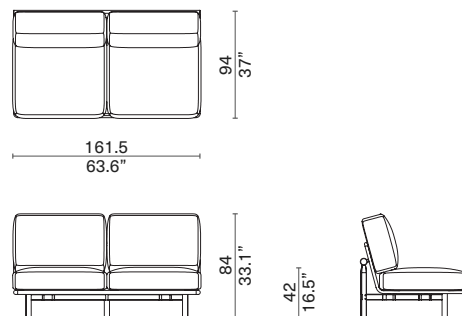

Sofa 3-seater without Arm
2016-3SWO

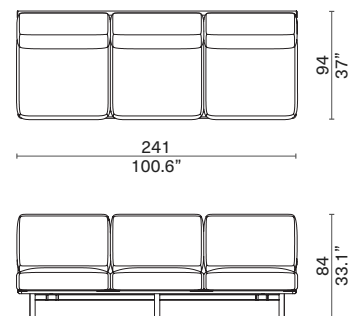

STILT

Designed by
Toan Nguyen

- Oak frame / Steel structure
/ Upholstered headboard &
rails

Sofa 3-seater
2016-3SEA

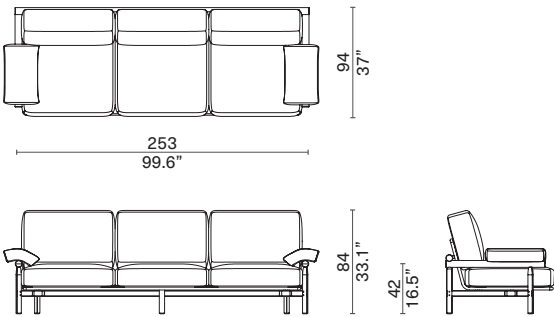

Sofa 3-seater with Left Arm
2016-3SWL

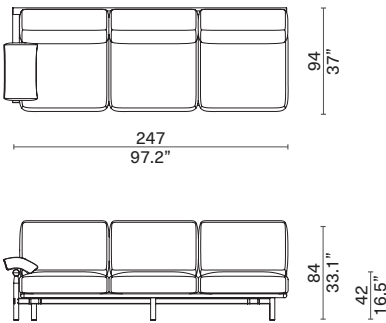

Sofa 3-seater with Right Arm
2016-3SWR

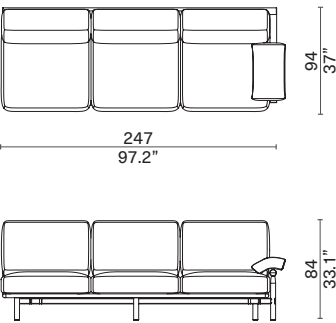

Sofa Corner
2017-M1CN

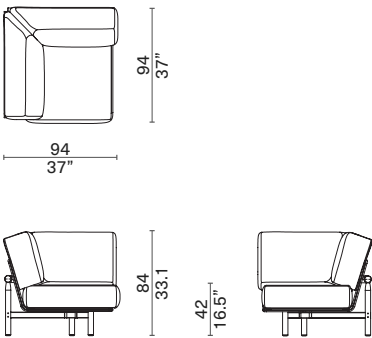

Sofa 2-seater Left Corner with Arm
2017-2LCW

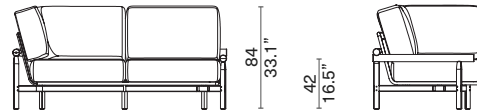
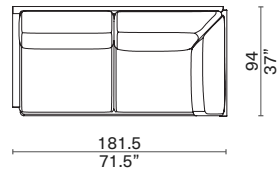

Sofa 2-seater Right Corner with Arm
2017-2RCW

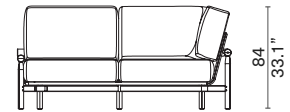
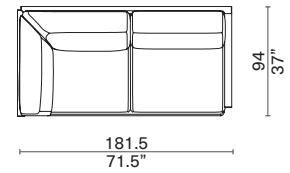

Sofa 2-seater Left Corner without Arm
2017-2LCO

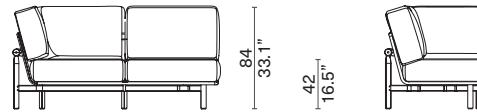
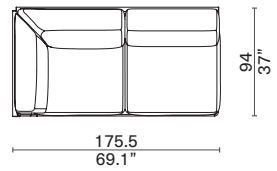

Sofa 2-seater Right Corner without Arm
2017-2RCO

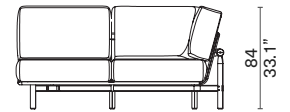
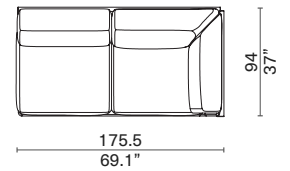

Sofa 3-seater Left Corner with Arm
2017-3LCW

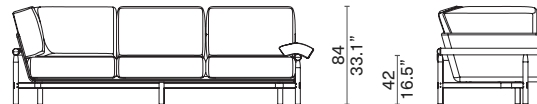
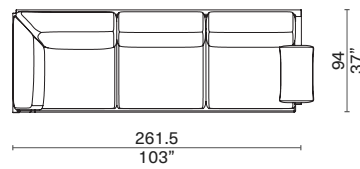

Sofa 3-seater Right Corner with Arm
2017-3RCW

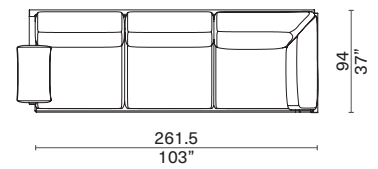

STILT

Designed by
Toan Nguyen

- Oak frame / Steel structure
/ Upholstered headboard &
rails

Sofa 3-seater Left Corner without Arm
2017-3LCO

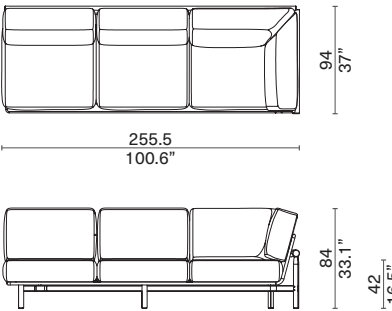

Sofa 3-seater Right Corner without Arm
2017-3RCO

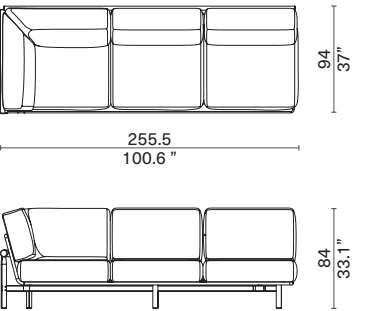

RECOMMENDED SET

Set A

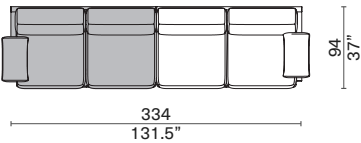

Set B

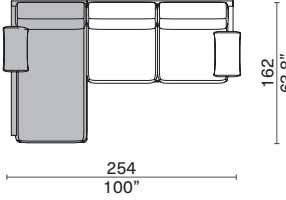

Set C

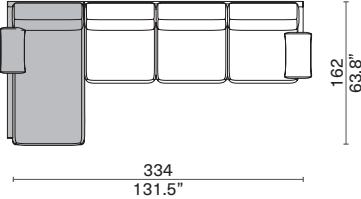

Set D

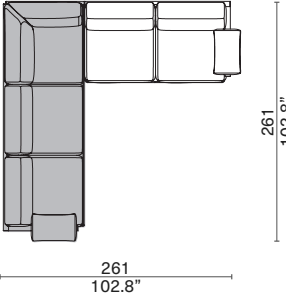

Set E

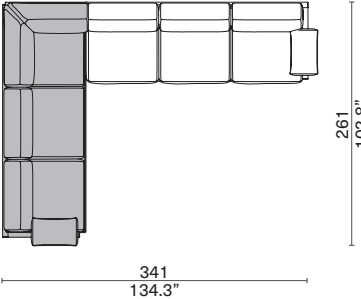

Set F

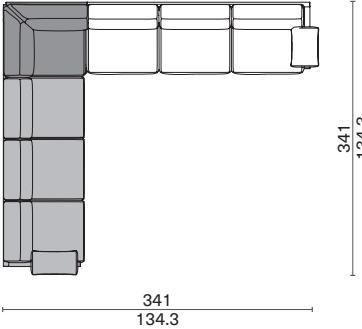

Square Table
1007-SQ

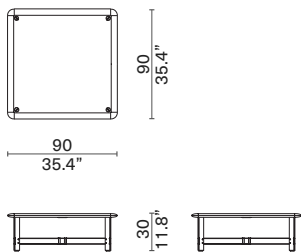

Rectangular Table - Small
1007-RE-SML

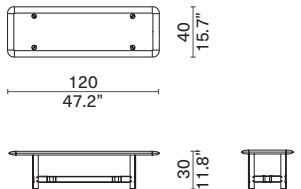

Rectangular Table - Large
1007-RE-LAG

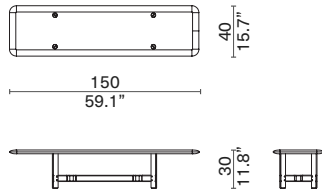

Round Table - Small
1007-CI-SML

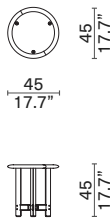

Round Table - Medium
1007-CI-MED

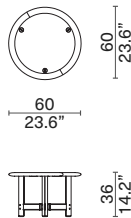

Round Table - Large
1007-CI-LAG

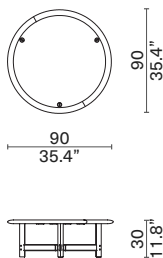

Round Table - Extra Large
1007-CI-EXL

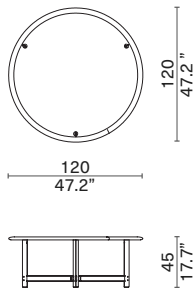

Bed - King
3008-KIN

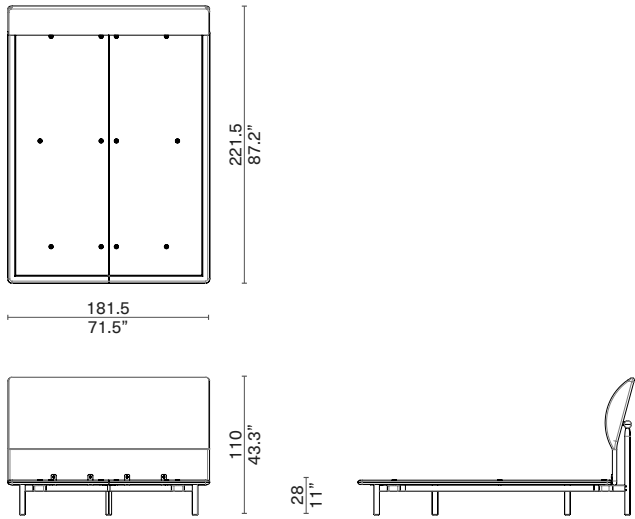

AVAILABLE SIZES

Super King Size

(Frame)

L241.5 W201.5 H110
L95.1" W79.3" H43.3"

(Mattress)

L220 W200 Thickness 30
L86.6" W78.7" Thickness 11.8"

King Size

L221.5 W181.5 H110
L87.2" W71.5" H43.3"

L200 W180 Thickness 30
L78.7" W70.9" Thickness 11.8"

Queen Size

L221.5 W161.5 H110
L87.2" W63.6" H43.3"

L200 W160 Thickness 30
L78.7" W63" Thickness 11.8"

US King Size

L225.5 W194.5 H110
L112.8" W76.6" H43.3"

L203 W193 Thickness 30
L79.9" W76" Thickness 11.8"

US Queen Size

L225.5 W154.5 H110
L112.8" W60.8" H43.3"

L203 W152 Thickness 30
L79.9" W59.8" Thickness 11.8"

Bench - Medium
2016-BENC-MED

Bench - Large
2016-BENC-LAG

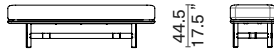
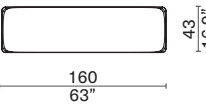
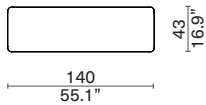

AMES

- Oak legs / Upholstery /
Brass

Low Dining Chair
2015-LDAL

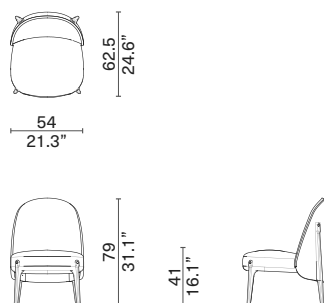

Dining Chair
2015

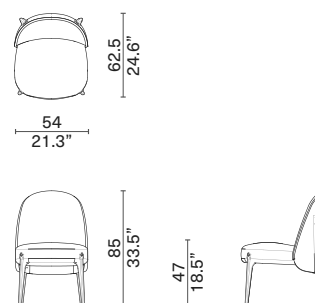

Counter Chair
2015-COCH

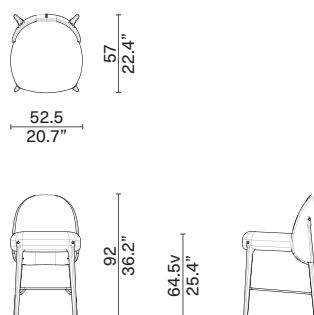

Bar Chair
2015-BACH

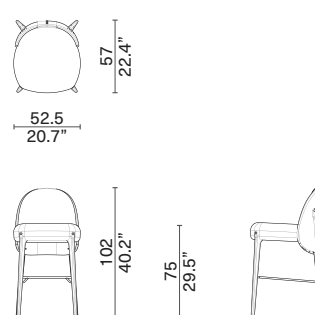

ASSEMBLY

- Oak / Upholstery seat /
Cast aluminium backrest

Dining Chair
2011

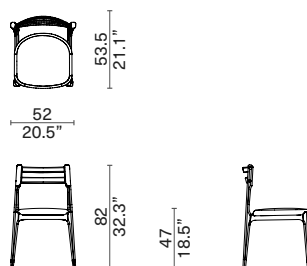

Dining Chair with Arms
2011-AMCH

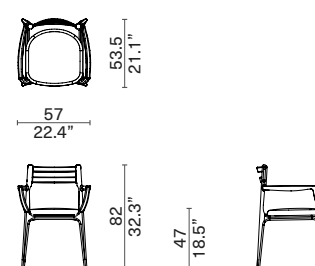

DRIFT

- Oak / Steel

Desk
237-DESK

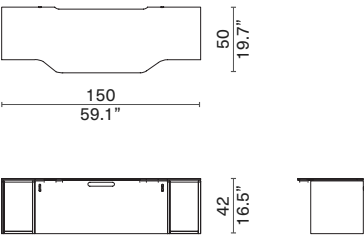

Double Drawer Unit
237-CABN

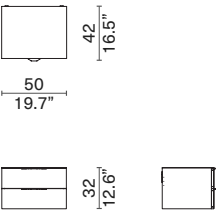

Triple Drawer Unit
237-DDCA

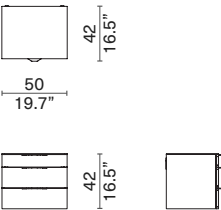

2 Doors Cabinet
237-CABN

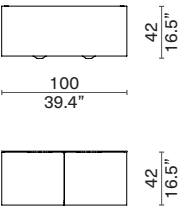

Drop-down Cabinet
237-DDCA

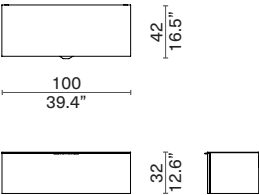

Shelf - Small
237-SHEL-SML

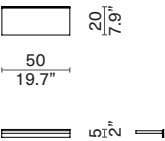

Shelf - Large
237-SHEL-LAG

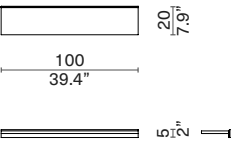

Shelf - Extra Large
237-SHEL-EXL

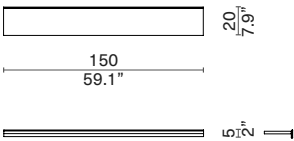

FAIF0

- Oak or Fir / Marble / Steel

Round Dining Table with Lazy Susan
- Medium
1010-CI-MED-ATM

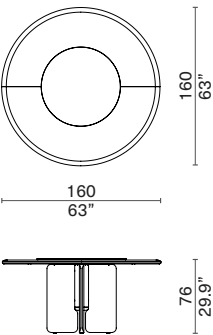

Round Dining Table with Lazy Susan
- Extra Large
1010-CI-EXL-ATM

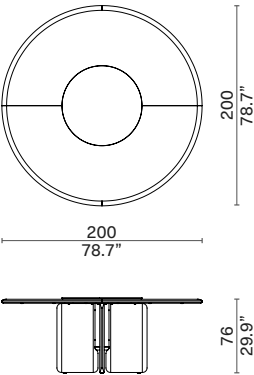

Round Dining Table - Small
1010-CI-SML

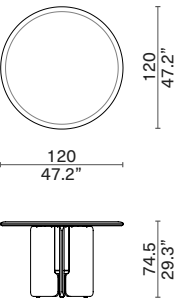

Round Dining Table - Medium
1010-CI-MED

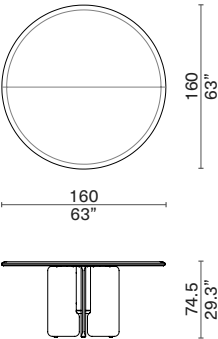

Rectangular Dining Table - Medium
1010-RE-MED

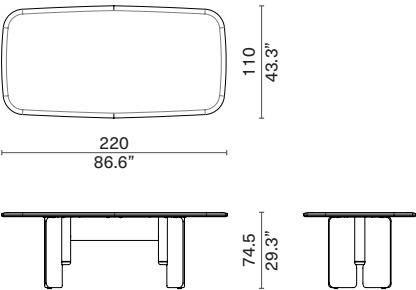

Rectangular Dining Table - Large
1010-RE-LAG

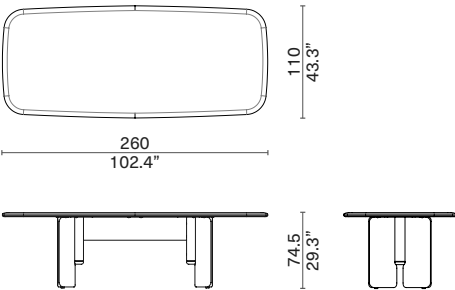

FAIFO

- Oak or Fir / Marble / Steel

Rectangular Dining Table - Extra Large
1010-RE-EXL

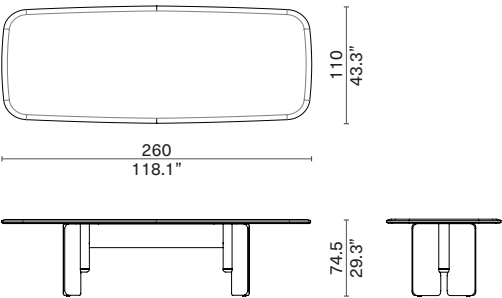

GUI

- Lacquer

Round Table - Small

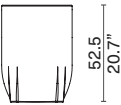
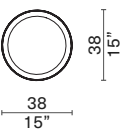

Round Table - Medium
1029-CI-MED

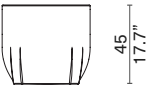
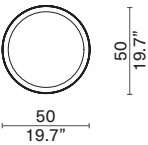

Round Table - Large
1029-CI-LAG

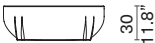
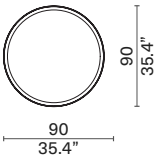

HIDA

- Oak frame / Upholstery /
Leather strap

Dining Chair with Arms
2022-AMCH

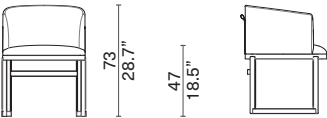
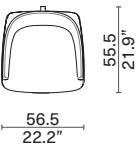

Dining Chair
2022-ALES

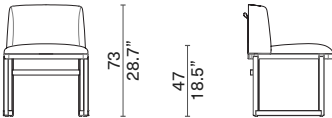
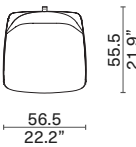

Low Dining Chair
2022-LDWA

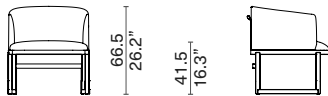
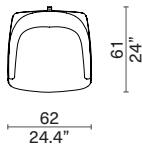

Sofa 2-seater
2022-BAQE

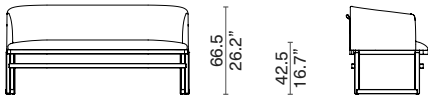
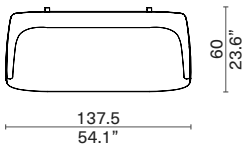

Lounge Chair
2022-LGCH

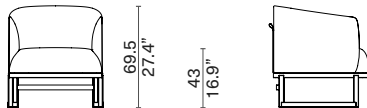
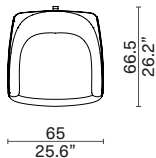

Bar Chair
2022-BACH

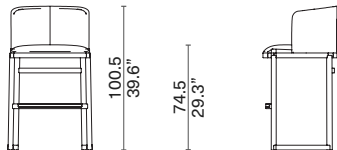
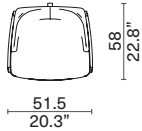

Counter Chair
2022-COCH

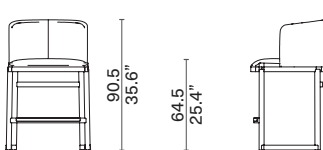
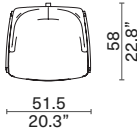

KNOT

- Oak
- Oak / Upholstery (chair)

Dining Chair
2026-ALES

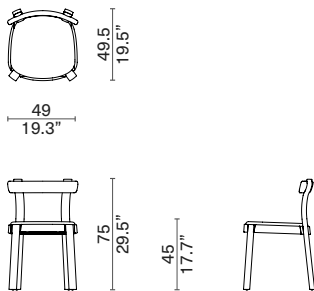

Round Dining Table - Small
1016-CI-SML

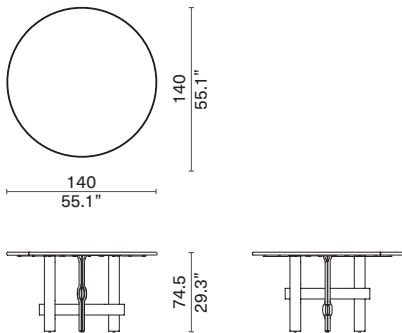

Round Dining Table - Medium
1016-CI-MED

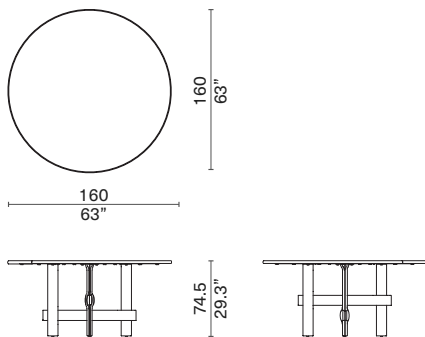

Round Dining Table - Large
1016-CI-LAG

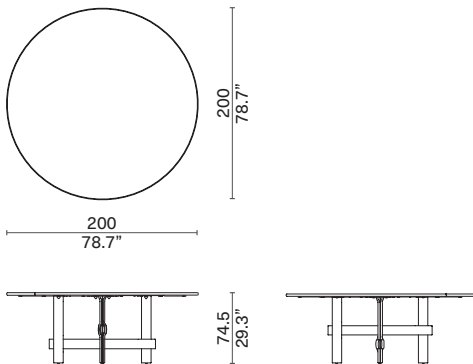

Rectangular Dining Table - Small
1016-RE-SML

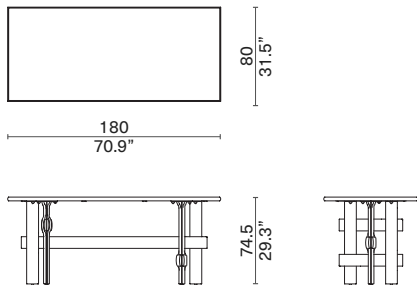

Rectangular Dining Table - Medium
1016-RE-MED

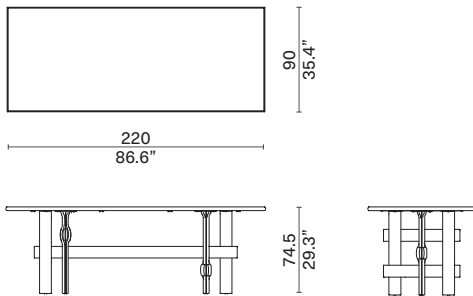

KNOT

- Oak

Rectangular Dining Table - Large
1016-RE-LAG

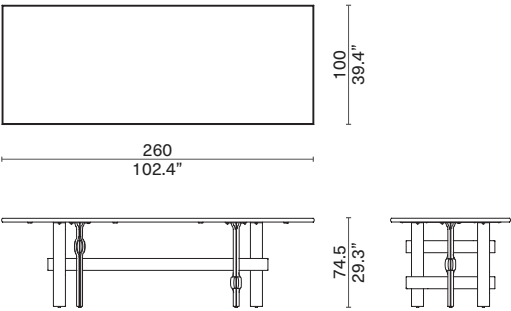

Rectangular Dining Table - Extra Large
1016-RE-EXL

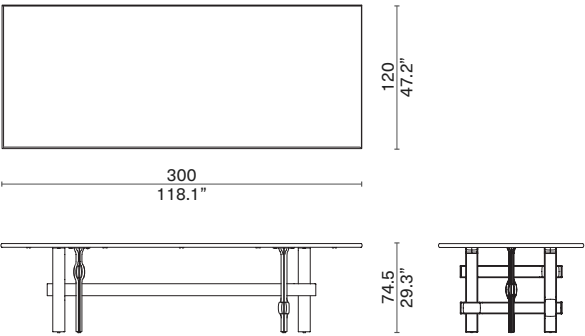

LOLA

- Oak frame / Upholstery

Sofa 2-seater
2021-CPS2

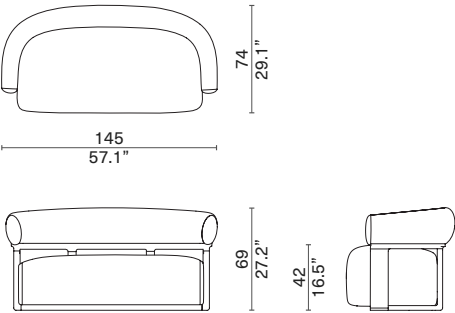

Lounge Chair
2021-CPS1

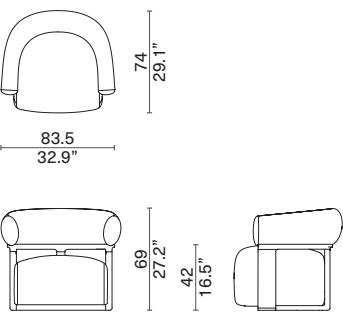

ODETTE

- Oak

Dining Table - Small
1017-RE-SML

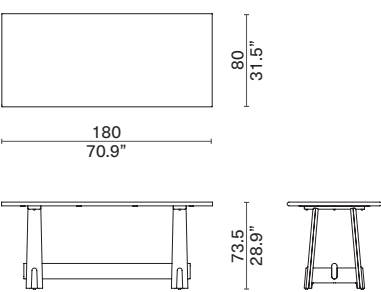

Dining Table - Medium
1017-RE-MED

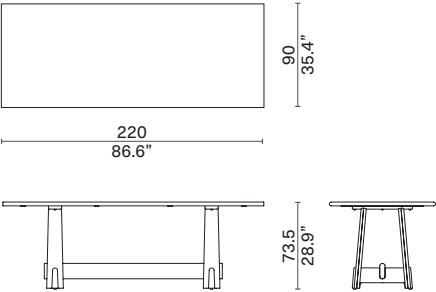

Dining Table - Large
1017-RE-LAG

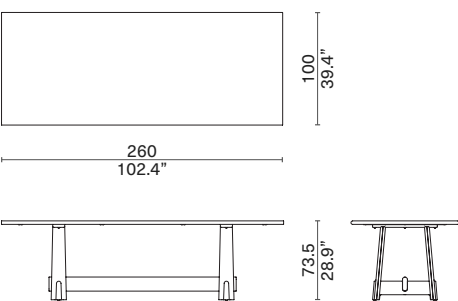

Dining Table - Extra Large
1017-RE-EXL

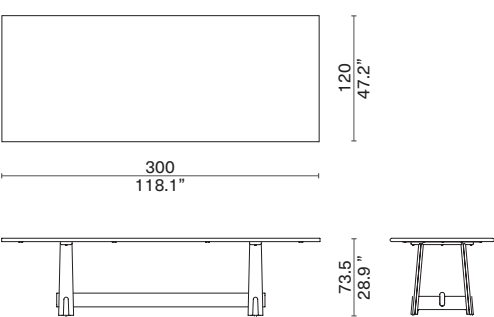

ODETTE

- Oak

Low Dining Table - Small
1017-LDTB-RE-SML

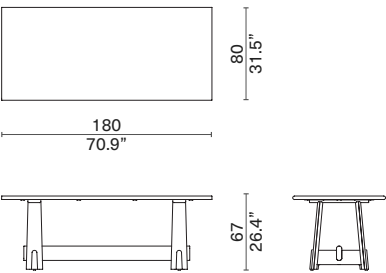

Low Dining Table - Medium
1017-LDTB-RE-MED

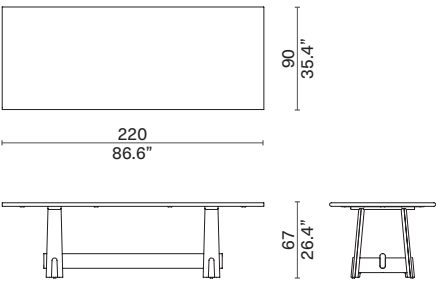

Low Dining Table - Large
1017-LDTB-RE-LAG

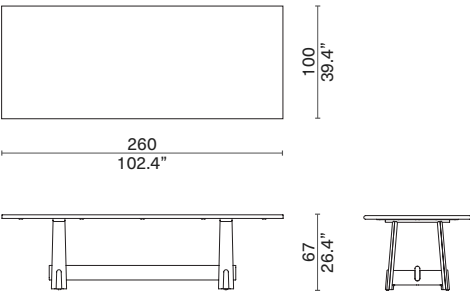

Low Dining Table - Extra Large
1017-LDTB-RE-EXL

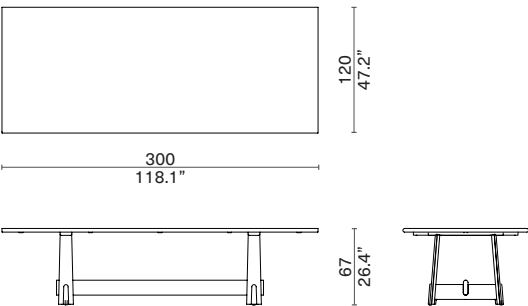

ODETTE

- Oak

Console - Small
1017-CONS-SML

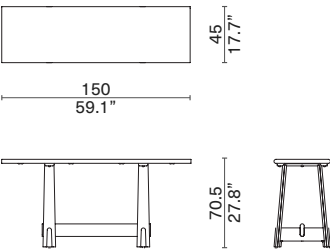

Console - Medium
1017-CONS-MED

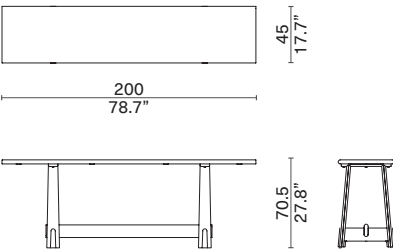

Bench - Small
2023-BENC-SML

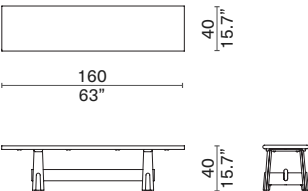

Bench - Large
2023-BENC-LAG

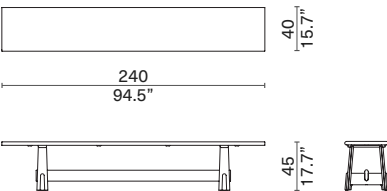

TORUS

- Fir top / Steel Pole /
Marble Base

Round Table - Small
1011-CI-SML

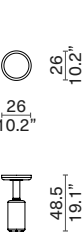

Round Table - Medium
1011-CI-MED

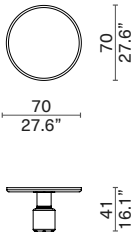

Round Table - Large
1011-CI-LAG

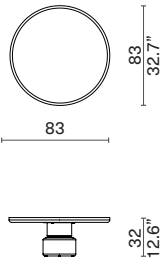

VICUNA

- Oak / Upholstered seat /
Blackened Steel

Dining Chair
2014

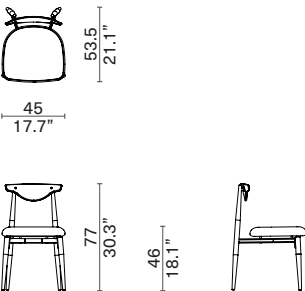

BABELE

- Blackened Steel

Babele - Medium
5006-MED

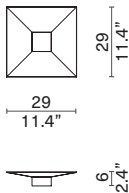

Babele - Large
5006-LAG

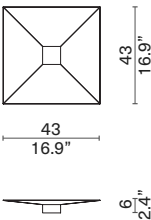

CHESS SET

- Chess board: Smoked oak & ash wood / blackened steel legs

- Chess pieces: Aluminium with antique brass / Blackened

- Container box: Oak & Pine

Chess Board
4004

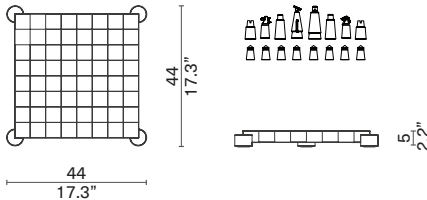

Container Box

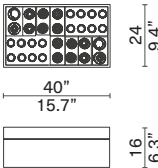

PIPE

- Lacquerware

Pipe - Medium
5005-MED

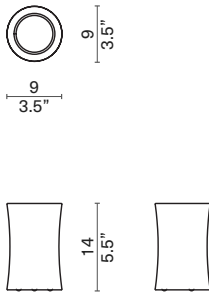

Pipe - Large
5005-LAG

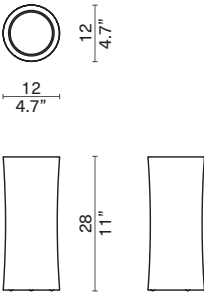

HEADQUARTERS

TDX Ice Factory, 19/45 Tran Dinh Xu, Cau Kho Ward,
District 1, Ho Chi Minh City, Vietnam

DISTRICT EIGHT NORTH AMERICA

313 Space
2F, Space #213, 313 South Centennial Str.,
High Point, North Carolina

DISTRICT EIGHT ITALIA S.R.L

Via Giovanni Falcone n.7
62029 Tolentino (MC) Italy

Sales, projects, and support:

info@districteight.com

(+84) 936 354 846 | (+39) 335 610 0055

www.districteight.com

Images credit:

P.03 - Sergey Sukhov / P.03 - Dave Weatherall / P.99
- Lily Tran / P.147 - Degaharu Tekouha / P.163 - Max
Do / P.179 - Vhil Destor / P.204 - Harry Doan



CONTACT US



WEBSITE



MATERIAL INDEX

DISPATCH



Vol.01



Vol.02



Vol.03





